

**BRANOC'S**  
ESTATES



**12 GLEBE CRESCENT, CHELMSFORD CM1**

OFFERS IN EXCESS OF £535,000

4 Bedrooms | 1 Bathrooms | 2 Receptions

## Floor Plan

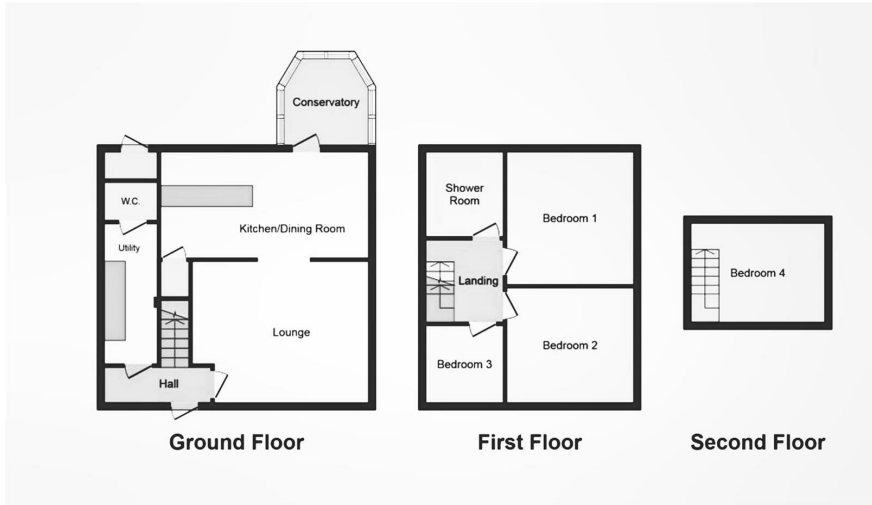

## Area Map



## Accommodation

- FOUR BEDROOMS
- EXTENDED GROUND FLOOR LIVING SPACE
- LOFT CONVERSION
- LARGE REAR GARDEN
- CONSERVATORY WITH FULLY INSULATED ROOF
- LARGE UTILITY ROOM
- CLOAKROOM
- GENEROUS DRIVEWAY PARKING
- CUL-DE-SAC LOCATION
- CLOSE TO BROOMFIELD HOSPITAL AND CHELMSFORD CITY CENTRE

## Viewing

Please contact us on 01376 386555 if you wish to arrange a viewing appointment for this property, or require further information.

## Energy Efficiency Graph

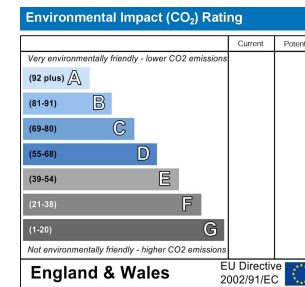
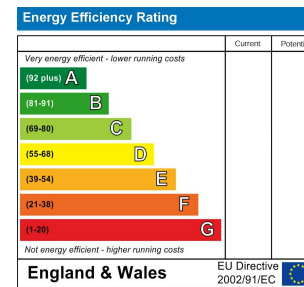

**Phone:** 01376 386555  
**Email:** info@branocsestates.co.uk  
**Website:** www.branocsestates.co.uk

Phoenix House 5 New Street  
 Braintree  
 Essex  
 CM7 1ER

Branocs endeavour to maintain accurate depictions of properties in Virtual Tours, Floor Plans and descriptions, however, these are intended only as a guide and purchasers must satisfy themselves by personal inspection.

