



Canon Pyon, Hereford, HR4 8NP

Offers Over £350,000

🛏️ 3 🚿 2 🚺 2



A Stunning Characterful 3 Double Bedroom Cottage, with off-road parking and private garden, located just outside Canon Pyon village in Herefordshire. Offered With No Onward Chain.

**Entrance Hall – Sitting Room – Kitchen/Dining Room – Utility/
Downstairs WC – Bedroom 1 With Ensuite – 2 Further Double
Bedrooms – Family Bathroom – Rear Garden – Front Patio – Off-
Road Parking**

Basking in the rural surroundings of Herefordshire just 5 miles from the City, this idyllic country cottage has enjoyed a full renovation, modernised in a high spec contemporary finish that perfectly complements the outstanding original features of the property such as exposed timber beams. A full range of integrated appliances in the kitchen, wood burning stove in the sitting room and ceiling speaker system in the downstairs make this a truly impressive family home.

Canon Pyon offers numerous amenities; Ofsted "Outstanding" primary school, pub, convenience store and post office. Only 5 miles away lies Weobley, the famed "Black & White Trail" village with GP surgery and secondary school, while the market town of Leominster is 8 miles and the full City amenities of Hereford are only 5 miles.

Practicalities

Herefordshire Council Tax Band 'A'
Electric Heating
Double Glazed Throughout
All Mains Services
Superfast Fibre Available



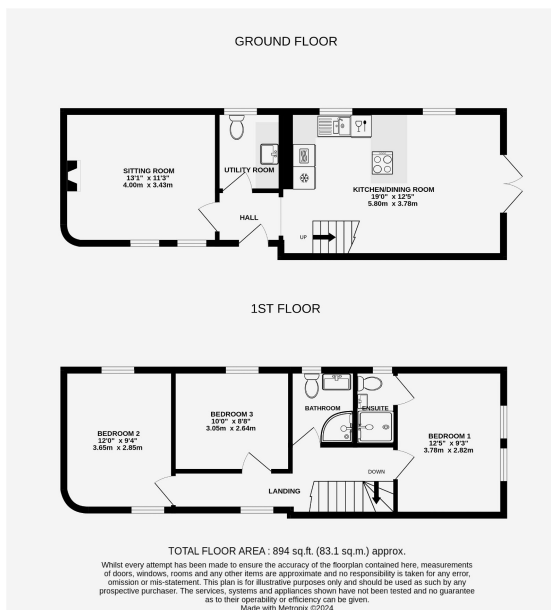

- Tastefully Finished Throughout
- Kitchen/Diner With Integrated Appliances
- Cosy Sitting Room With Woodburner
- 3 Double Bedrooms
- Full Of Character Features
- Offered With No Onward Chain

