

*To arrange a viewing contact us  
today on 01268 777400*



ASPIRE

ASPIRE



ASPIRE



ASPIRE



ASPIRE

## Windsor Road, Basildon Guide price £800,000

Set on a generous plot, this exceptional property offers a unique blend of style and comfort. Inside, the home features a beautifully hand-finished kitchen, perfect for culinary enthusiasts. Both double bedrooms come complete with luxurious en-suite bathrooms, adding a touch of privacy and sophistication. The spacious interior also boasts two elegant sitting rooms, providing ample space for relaxation or entertaining. The extensive grounds complement the interior's charm, making this property an ideal retreat for those seeking both indoor and outdoor luxury. Guide Price £800,000 to £850,000

Dimensions given in meters

Bedroom one (4.62 x 3.66)

Bedroom two (3.51 x 3.35)

Bedroom three (4.93 x 3.45)

Lounge/Dinner (7.42 x 4.27)

Conservatory (5.03 x 2.92)

Kitchen (4.5 x 3.15)

Reception Room (5.84 x 5.05)

Garage/Workshop (15.98 x 5.18)

# ASPIRE

ESTATE AGENTS

## BRAMBLES

### BOWERS GIFFORD

🏠 x4 🚗 x3

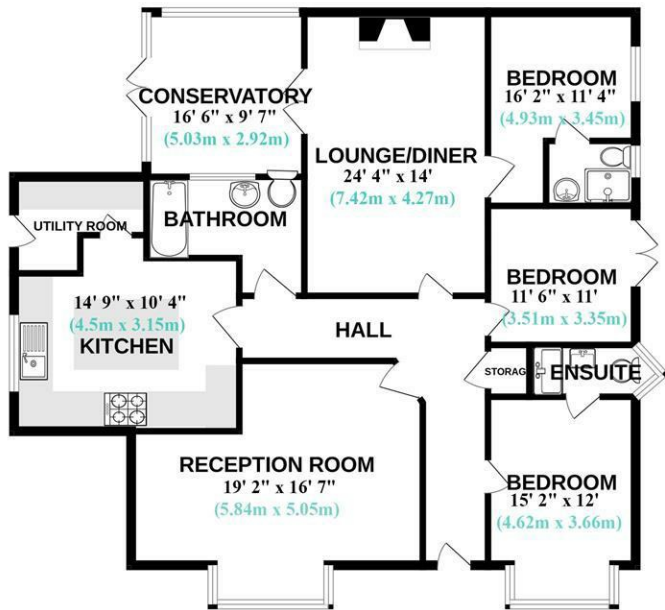

Energy Efficiency Rating		Current	Potential
Very energy efficient - lower running costs			
(92 plus) A			
(81-91) B			
(69-80) C			
(55-68) D			
(39-54) E			
(21-38) F			
(1-20) G			
Not energy efficient - higher running costs			
England & Wales			
EU Directive 2002/91/EC			
Environmental Impact (CO <sub>2</sub> ) Rating		Current	Potential
Very environmentally friendly - lower CO <sub>2</sub> emissions			
(92 plus) A			
(81-91) B			
(69-80) C			
(55-68) D			
(39-54) E			
(21-38) F			
(1-20) G			
Not environmentally friendly - higher CO <sub>2</sub> emissions			
England & Wales			
EU Directive 2002/91/EC			



rightmove.co.uk  
The UK's number one property website

Zoopla.co.uk

Under the Property Misdescriptions Act 1991 we make every effort to ensure our sales details are accurate but they are a general outline and do not constitute any part of an offer or contract. Any services, equipment and fittings have not been tested and no warranty can be given as to their condition. We strongly recommend that all the information provided be verified by your advisors and in particular, measurements required for a specific purpose such as fitted furniture or carpets. Please tell us if you have any problems and members of our branches will help either over the phone or in person. A copy of our complaints procedure is available on request. The details are issued on the strict understanding that any negotiations in respect of the property named herein are conducted through Aspire Estate Agents.