

**To arrange a viewing contact us
today on 01268 777400**



Seamore Walk, Benfleet £335,000

GARAGE AND PARKING AT REAR - Located in the heart of Benfleet, this beautifully presented three-bedroom family home in Seamore Walk is an excellent opportunity for those seeking a modern and move-in-ready property. Offered with no onward chain, this home is perfect for first-time buyers, growing families, or those looking to downsize.

Step inside to discover a bright and spacious open-plan lounge and dining area, designed for both relaxation and entertaining. The modern fitted kitchen boasts sleek cabinetry, ample storage, and high-quality appliances, making it a fantastic space for culinary enthusiasts.

Upstairs, you'll find three well-proportioned bedrooms, providing comfortable living space for the whole family. The contemporary family bathroom is finished to a high standard, offering a stylish suite with elegant fixtures and fittings.

Externally, the low-maintenance rear garden is an ideal space to unwind, featuring a patio area and artificial lawn, perfect for outdoor dining or enjoying the sunshine with minimal upkeep.

Situated in a sought-after location, this home benefits from excellent local amenities, reputable schools, and convenient transport links, making it a fantastic choice for modern family living.

Don't miss out—book your viewing today!

www.aspireestateagents.co.uk

LOUNGE

16'4 x 13'7 (4.98m x 4.14m)

DINING ROOM

11'5 x 7'8 (3.48m x 2.34m)

KITCHEN

11'5 x 8'1 (3.48m x 2.46m)

BEDROOM ONE

14'0 x 9'9 (4.27m x 2.97m)

BEDROOM TWO

11'7 x 9'8 (3.53m x 2.95m)

BEDROOM THREE

10'10 x 6'1 (3.30m x 1.85m)

BATHROOM**LOW MAINTENANCE GARDEN****GARAGE IN BLOCK**

GROUND FLOOR

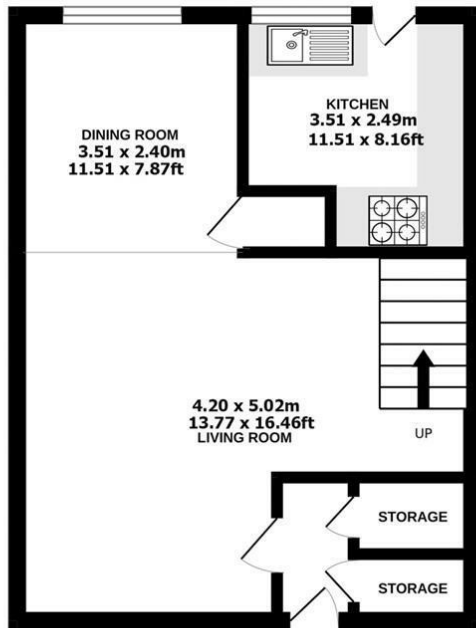

1ST FLOOR

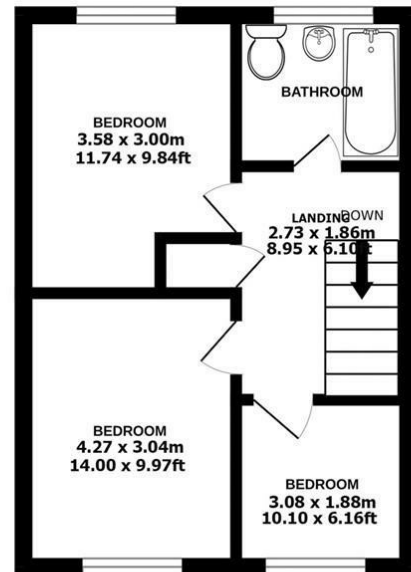

ASPIRE
ESTATE AGENTS
SEAMORE WALK
BENFLEET

🚗 x3 🚿 x1

Energy Efficiency Rating		Current	Potential
Very energy efficient - lower running costs			
(92 plus)	A		
(81-91)	B		
(69-80)	C		
(55-68)	D		
(39-54)	E		
(21-38)	F		
(1-20)	G		
Not energy efficient - higher running costs			
England & Wales		EU Directive 2002/91/EC	
Environmental Impact (CO ₂) Rating		Current	Potential
Very environmentally friendly - lower CO ₂ emissions			
(92 plus)	A		
(81-91)	B		
(69-80)	C		
(55-68)	D		
(39-54)	E		
(21-38)	F		
(1-20)	G		
Not environmentally friendly - higher CO ₂ emissions			
England & Wales		EU Directive 2002/91/EC	

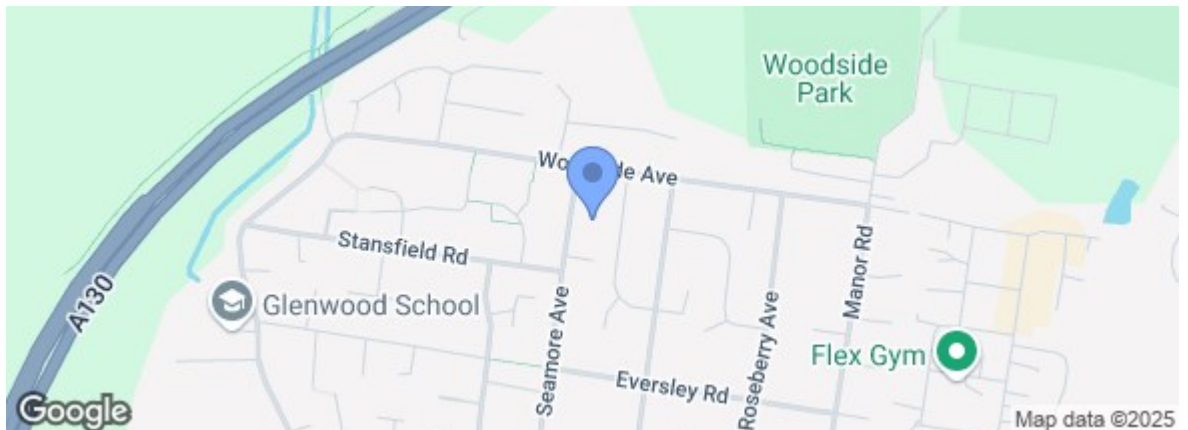

 **rightmove**.co.uk
The UK's number one property website

Zoopla.co.uk

Under the Property Misdescriptions Act 1991 we make every effort to ensure our sales details are accurate but they are a general outline and do not constitute any part of an offer or contract. Any services, equipment and fittings have not been tested and no warranty can be given as to their condition. We strongly recommend that all the information provided be verified by your advisors and in particular, measurements required for a specific purpose such as fitted furniture or carpets. Please tell us if you have any problems and members of our branches will help either over the phone or in person. A copy of our complaints procedure is available on request. The details are issued on the strict understanding that any negotiations in respect of the property named herein are conducted through Aspire Estate Agents.