

**To arrange a viewing contact us  
today on 01268 777400**



## **London Road, Benfleet Asking price £200,000**

Offered with no onward chain, this well-presented two-bedroom first-floor apartment boasts a remaining lease of over 170 years. Situated in Saxon Court, just off London Road in Benfleet, the property is conveniently located close to local amenities, including shops, schools, a nearby park, and excellent bus links.

Ideal for first-time buyers or investors, this apartment presents a fantastic buy-to-let opportunity. With relatively low service charges and an allocated parking space, it offers both comfort and convenience in a sought-after location.

**Lounge/Diner**

14'0" x 10'11" (4.29 x 3.34)

**Kitchen**

8'4" x 6'11" (2.56 x 2.13)

**Bedroom One**

12'0" x 7'11" (3.67 x 2.42)

**Bedroom Two**

8'7" x 6'11" (2.63 x 2.13)



## GROUND FLOOR

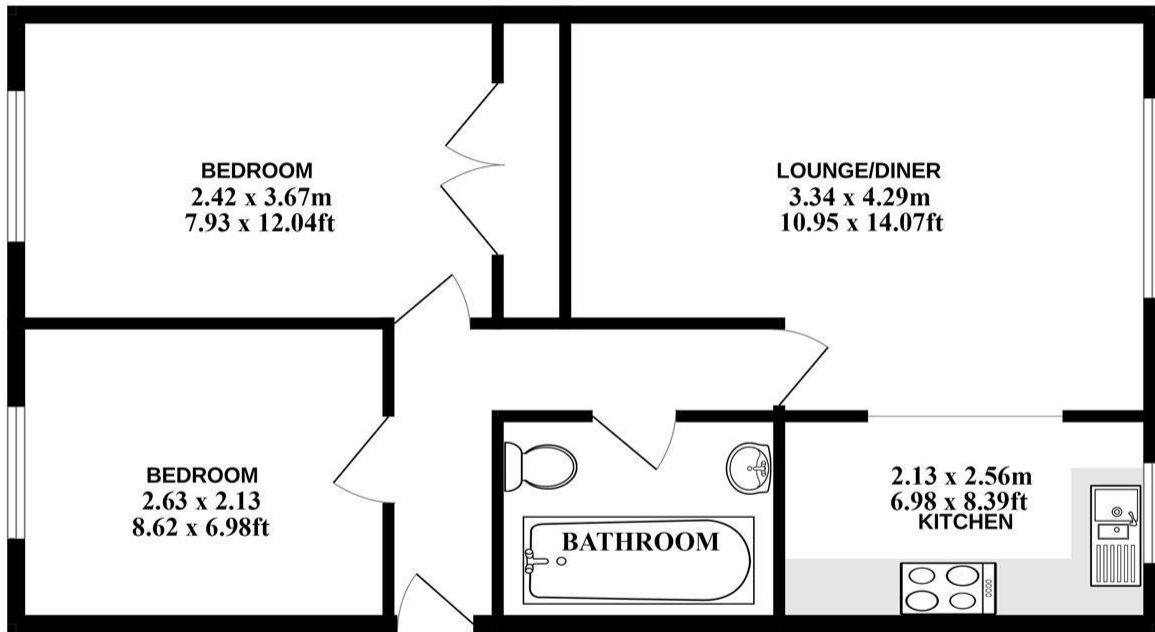

**ASPIRE**  
ESTATE AGENTS  
**SAXTON COURT**  
**BENFLEET**  
🏠 x2 🚗 x1

Energy Efficiency Rating		Current	Potential
Very energy efficient - lower running costs			
(92 plus)	A		
(81-91)	B		
(69-80)	C		
(55-68)	D		
(39-54)	E		
(21-38)	F		
(1-20)	G		
Not energy efficient - higher running costs			
England & Wales		EU Directive 2002/91/EC	
Environmental Impact (CO <sub>2</sub> ) Rating		Current	Potential
Very environmentally friendly - lower CO <sub>2</sub> emissions			
(92 plus)	A		
(81-91)	B		
(69-80)	C		
(55-68)	D		
(39-54)	E		
(21-38)	F		
(1-20)	G		
Not environmentally friendly - higher CO <sub>2</sub> emissions			
England & Wales		EU Directive 2002/91/EC	

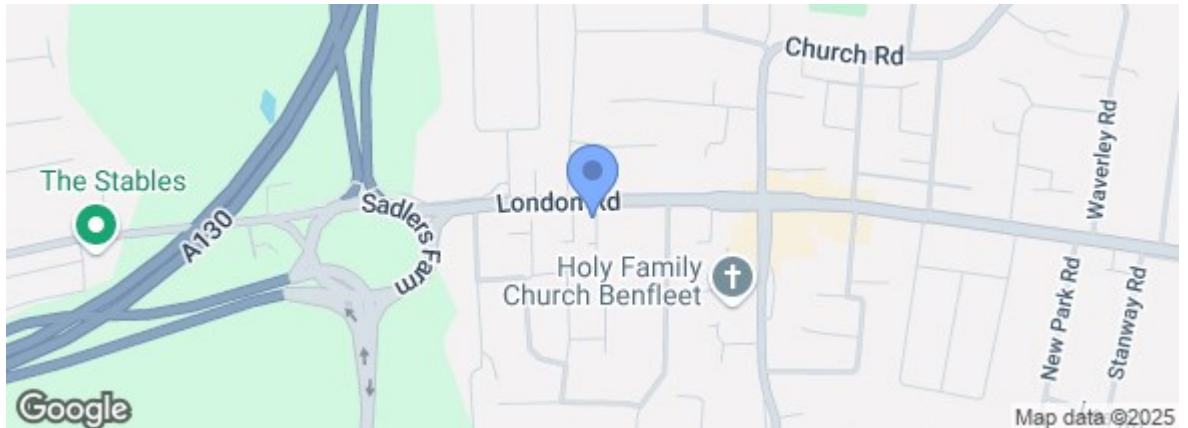

rightmove.co.uk  
The UK's number one property website

Zoopla.co.uk

Under the Property Misdescriptions Act 1991 we make every effort to ensure our sales details are accurate but they are a general outline and do not constitute any part of an offer or contract. Any services, equipment and fittings have not been tested and no warranty can be given as to their condition. We strongly recommend that all the information provided be verified by your advisors and in particular, measurements required for a specific purpose such as fitted furniture or carpets. Please tell us if you have any problems and members of our branches will help either over the phone or in person. A copy of our complaints procedure is available on request. The details are issued on the strict understanding that any negotiations in respect of the property named herein are conducted through Aspire Estate Agents.