

**To arrange a viewing contact us
today on 01268 777400**



Magnolia Close, Canvey Island Guide price £550,000

CHECK OUT THE MARKETING VIDEO - We are thrilled to present this stunning four-bedroom home, nestled in a peaceful cul-de-sac just moments from the seafront. £550,000 - £575,000

On the ground floor, you'll find a spacious, modern kitchen featuring an island with ample worktop space, storage, and integrated appliances—including a built-in wine cooler. The generous lounge offers a warm, inviting atmosphere with a cozy fireplace and bi-fold doors, leading seamlessly into a charming sunroom.

This level also includes a separate dining room and a dedicated home office, both of which can easily be transformed into additional bedrooms if needed. A convenient WC completes the ground floor.

Upstairs, there are four well-proportioned bedrooms, including a master suite with a large ensuite bathroom. A spacious family bathroom serves the remaining bedrooms.

The low-maintenance, south-west facing garden is a true highlight, featuring astro turf and a beautifully designed garden room with an outdoor kitchen—perfect for entertaining. The converted garage offers two versatile rooms, ideal for a home gym, games room, or home business. It also presents an excellent opportunity for those working remotely or running a business from home. Additional loft space provides even more storage options.

This exceptional home offers both style and functionality in a prime location—don't miss the opportunity to make it yours.

www.aspireestateagents.co.uk

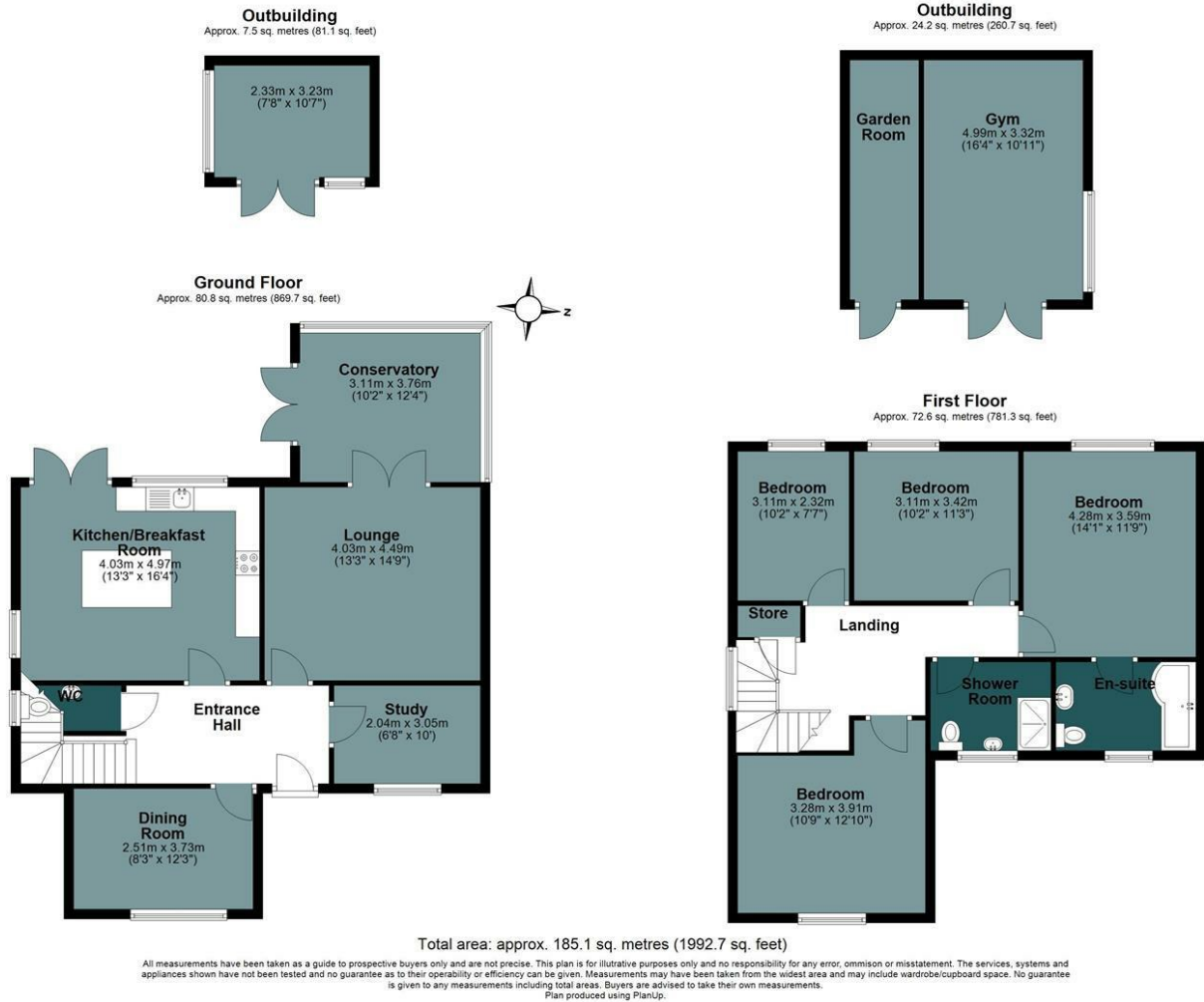

Energy Efficiency Rating		Current	Potential
Very energy efficient - lower running costs			
(92 plus)	A		
(81-91)	B		
(69-80)	C		
(55-68)	D		
(39-54)	E		
(21-38)	F		
(1-20)	G		
Not energy efficient - higher running costs			
England & Wales			
EU Directive 2002/91/EC			
Environmental Impact (CO ₂) Rating		Current	Potential
Very environmentally friendly - lower CO ₂ emissions			
(92 plus)	A		
(81-91)	B		
(69-80)	C		
(55-68)	D		
(39-54)	E		
(21-38)	F		
(1-20)	G		
Not environmentally friendly - higher CO ₂ emissions			
England & Wales			
EU Directive 2002/91/EC			



Under the Property Misdescriptions Act 1991 we make every effort to ensure our sales details are accurate but they are a general outline and do not constitute any part of an offer or contract. Any services, equipment and fittings have not been tested and no warranty can be given as to their condition. We strongly recommend that all the information provided be verified by your advisors and in particular, measurements required for a specific purpose such as fitted furniture or carpets. Please tell us if you have any problems and members of our branches will help either over the phone or in person. A copy of our complaints procedure is available on request. The details are issued on the strict understanding that any negotiations in respect of the property named herein are conducted through Aspire Estate Agents.