

*To arrange a viewing contact us
today on 01268 777400*



Kings Crescent, Basildon Offers in excess of £400,000

*****Potential To Extend***** Aspire Estate Agents are pleased to present this charming 3-bedroom semi-detached bungalow, boasting a large rear garden with immense potential for full extension. The property is chain-free and ready to move into, making it an ideal opportunity for those looking for a hassle-free move. Situated in the highly desirable and family-friendly Steeple View area, the home offers excellent access to the A127 and is within a short drive of Wickford station, with Laindon station just over a 20-minute walk away. Conveniently, you'll also find Pipp's Hill Retail Park, Mayflower Retail Park, Basildon Sporting Village, and Festival Leisure Park nearby, offering plenty of amenities for all ages. With no onward chain, this property is not to be missed—internal viewings are strongly recommended.

Ground Floor

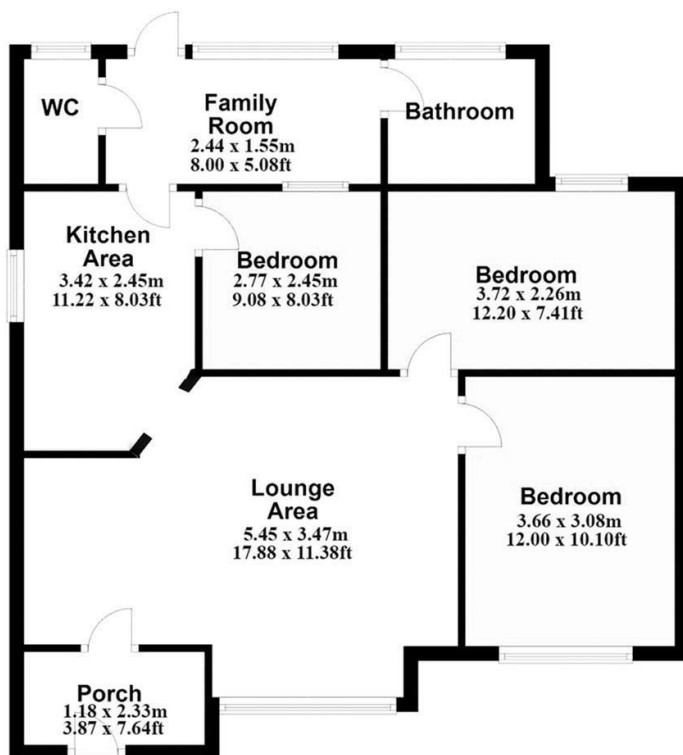

ASPIRE
KINGS CRESCENT
BASILDON
 ESTATE AGENTS
 ☎ x3 📠 x2

| Energy Efficiency Rating | | Current | Potential |
|---|--|-------------------------|-----------|
| Very energy efficient - lower running costs | | | |
| (92 plus) A | | | |
| (81-91) B | | | |
| (69-80) C | | | |
| (55-68) D | | | |
| (39-54) E | | | |
| (21-38) F | | | |
| (1-20) G | | | |
| Not energy efficient - higher running costs | | | |
| England & Wales | | EU Directive 2002/91/EC | |
| Environmental Impact (CO ₂) Rating | | Current | Potential |
| Very environmentally friendly - lower CO ₂ emissions | | | |
| (92 plus) A | | | |
| (81-91) B | | | |
| (69-80) C | | | |
| (55-68) D | | | |
| (39-54) E | | | |
| (21-38) F | | | |
| (1-20) G | | | |
| Not environmentally friendly - higher CO ₂ emissions | | | |
| England & Wales | | EU Directive 2002/91/EC | |

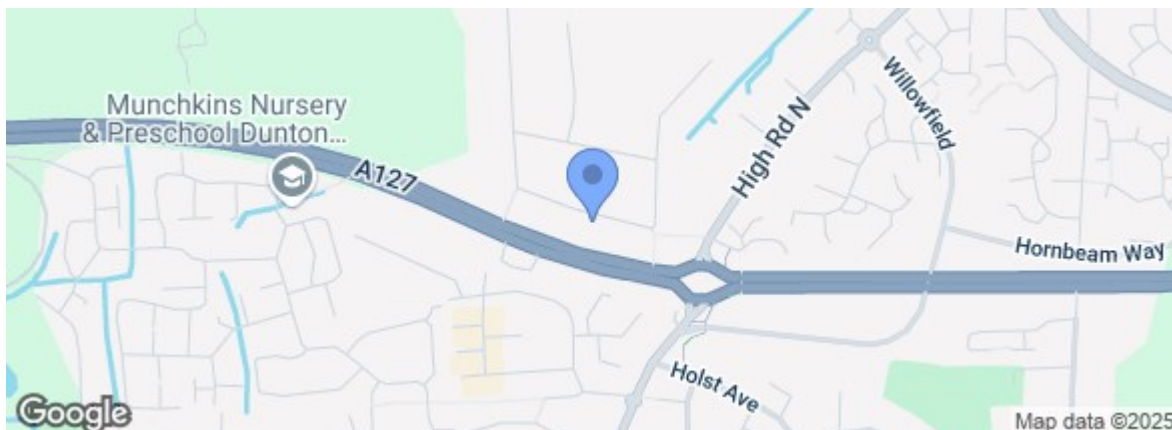

rightmove.co.uk
 The UK's number one property website

Zoopla.co.uk

Under the Property Misdescriptions Act 1991 we make every effort to ensure our sales details are accurate but they are a general outline and do not constitute any part of an offer or contract. Any services, equipment and fittings have not been tested and no warranty can be given as to their condition. We strongly recommend that all the information provided be verified by your advisors and in particular, measurements required for a specific purpose such as fitted furniture or carpets. Please tell us if you have any problems and members of our branches will help either over the phone or in person. A copy of our complaints procedure is available on request. The details are issued on the strict understanding that any negotiations in respect of the property named herein are conducted through Aspire Estate Agents.