

**To arrange a viewing contact us
today on 01268 777400**



Challock Lees, Basildon Guide price £350,000

Stunning Two-Bedroom Semi-Detached Home in the Sought-After "Eversley" Location – No Chain!

Guide Price £350,000-£360,000

Aspire Estate Agents are delighted to present this beautifully presented two-bedroom semi-detached home, ideally situated in the highly desirable Eversley area. Boasting immaculate modern décor throughout, this property is perfect for first-time buyers, small families, or those looking to downsize.

The spacious lounge/dining room provides a warm and inviting space, filled with natural light from the charming bay window. The modern fitted kitchen/breakfast room offers sleek cabinetry, built-in appliances, and ample space for dining.

Upstairs, both generously sized bedrooms provide comfortable living, while the newly fitted family bathroom showcases a stylish suite with full tiling for a contemporary finish.

The low-maintenance rear garden is perfect for relaxing, with direct access to a garage and two private off-street parking spaces—a fantastic bonus in this location. The front garden has been beautifully landscaped, enhancing the home's curb appeal.

Nestled in a peaceful cul-de-sac, this home is within the catchment area for the highly regarded Eversley Primary School and just a short walk to Pitsea Train Station, providing a direct link to London Fenchurch Street in just 39 minutes.

www.aspireestateagents.co.uk

Living Room: 5.40m x 4.03m (17'8" x 13'3")

Kitchen: 3.00m x 4.03m (9'10" x 13'3")

Bedroom One: 3.00m x 4.03m (9'10" x 13'3")

Bedroom Two: 3.00m x 4.03m (9'10" x 13'3")

Bathroom:

Hallway:

Staircase/Landing:

Total Area: Approx. 71.1 sq. metres (765.1 sq. feet)

Access to Private Garage and 2 Off-Street Parking Spaces

Ground Floor

Approx. 36.6 sq. metres (394.5 sq. feet)

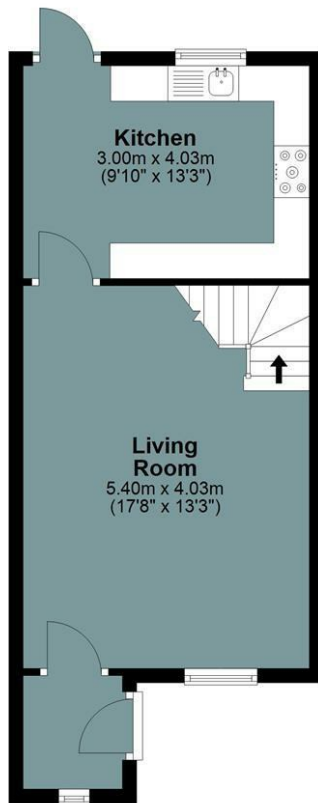

First Floor

Approx. 34.4 sq. metres (370.6 sq. feet)



Total area: approx. 71.1 sq. metres (765.1 sq. feet)

All measurements have been taken as a guide to prospective buyers only and are not precise. This plan is for illustrative purposes only and no responsibility for any error, omission or misstatement. The services, systems and appliances shown have not been tested and no guarantee as to their operability or efficiency can be given. Measurements may have been taken from the widest area and may include wardrobe/cupboard space. No guarantee is given to any measurements including total areas. Buyers are advised to take their own measurements.

Plan produced using PlanUp.

Energy Efficiency Rating	
	Current
Very energy efficient - lower running costs	
(92 plus) A	
(81-91) B	
(69-80) C	
(55-68) D	
(39-54) E	
(21-38) F	
(1-10) G	
Not energy efficient - higher running costs	
England & Wales	EU Directive 2002/91/EC
Environmental Impact (CO ₂) Rating	
	Current
Very environmentally friendly - lower CO ₂ emissions	
(92 plus) A	
(81-91) B	
(69-80) C	
(55-68) D	
(39-54) E	
(21-38) F	
(1-10) G	
Not environmentally friendly - higher CO ₂ emissions	
England & Wales	EU Directive 2002/91/EC

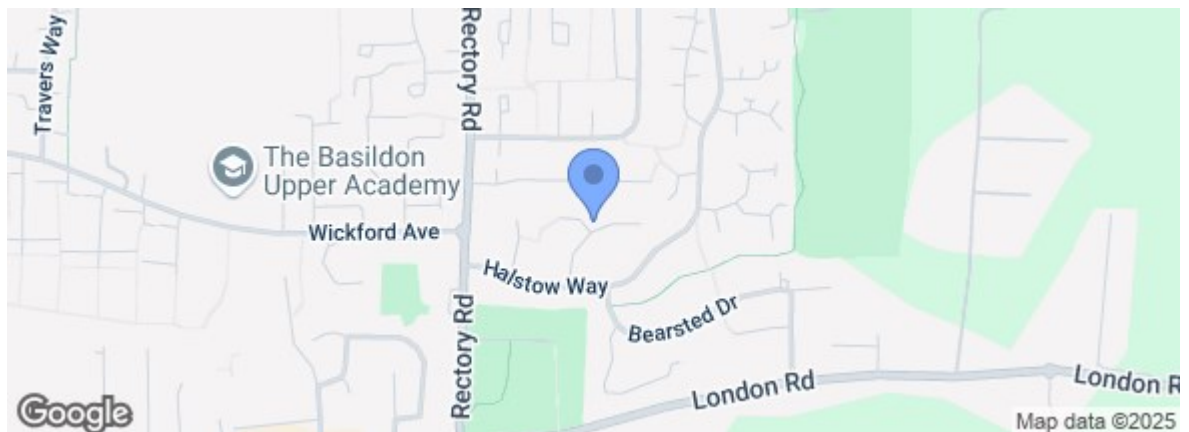

Under the Property Misdescriptions Act 1991 we make every effort to ensure our sales details are accurate but they are a general outline and do not constitute any part of an offer or contract. Any services, equipment and fittings have not been tested and no warranty can be given as to their condition. We strongly recommend that all the information provided be verified by your advisors and in particular, measurements required for a specific purpose such as fitted furniture or carpets. Please tell us if you have any problems and members of our branches will help either over the phone or in person. A copy of our complaints procedure is available on request. The details are issued on the strict understanding that any negotiations in respect of the property named herein are conducted through Aspire Estate Agents.