

*To arrange a viewing contact us
today on 01268 777400*



Alma Avenue, Hornchurch Guide price £400,000

ASPIRE ESTATE AGENTS is pleased to offer this two double-bedroom semi-detached bungalow with off-street parking and NO ONWARD CHAIN. Recently refurbished, the property features a large rear garden and is conveniently located close to Hornchurch train station and within the catchment area for Hacton School.
Available now.

FRONT PORCH

HALLWAY

Loft hatch for access. Doors leading to:

BATHROOM

LOUNGE

19'7 x 10'7 (5.97m x 3.23m)

BEDROOM ONE

12'3 to bay x 10'7 (3.73m to bay x 3.23m)

BEDROOM TWO

9'10 x 8'11 (3.00m x 2.72m)

KITCHEN

10' x 8'10 (3.05m x 2.69m)

CONSERVATORY

REAR GARDEN

OFF STREET PARKING

To front

Ground Floor

Approx. 76.7 sq. metres (825.8 sq. feet)

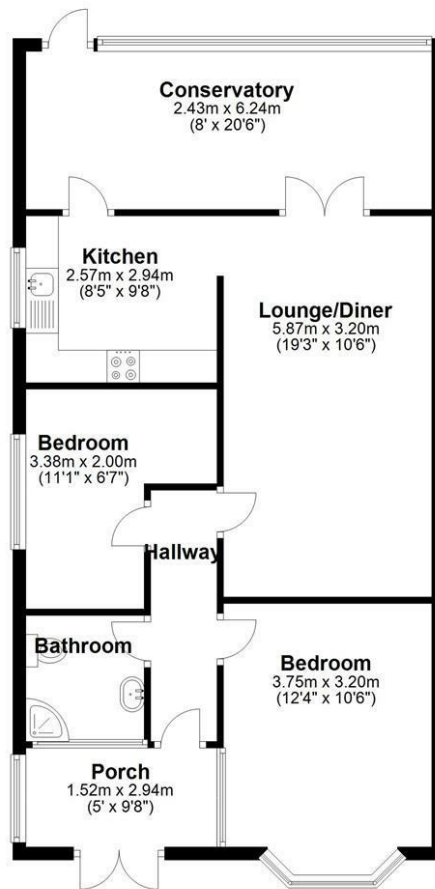

Total area: approx. 76.7 sq. metres (825.8 sq. feet)
Alma ave, Hornchurch

Energy Efficiency Rating		
	Current	Potential
Very energy efficient - lower running costs		
(92 plus) A		85
(81-91) B		
(69-80) C		60
(55-68) D		
(39-54) E		
(21-38) F		
(1-20) G		
Not energy efficient - higher running costs		
England & Wales EU Directive 2002/91/EC		
Environmental Impact (CO ₂) Rating		
	Current	Potential
Very environmentally friendly - lower CO ₂ emissions		
(92 plus) A		86
(81-91) B		
(69-80) C		59
(55-68) D		
(39-54) E		
(21-38) F		
(1-20) G		
Not environmentally friendly - higher CO ₂ emissions		
England & Wales EU Directive 2002/91/EC		

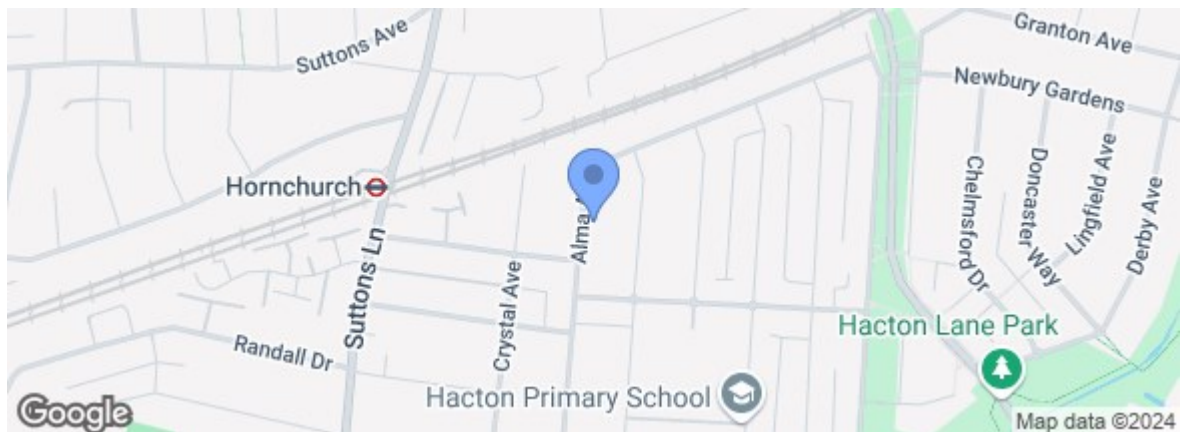

Under the Property Misdescriptions Act 1991 we make every effort to ensure our sales details are accurate but they are a general outline and do not constitute any part of an offer or contract. Any services, equipment and fittings have not been tested and no warranty can be given as to their condition. We strongly recommend that all the information provided be verified by your advisors and in particular, measurements required for a specific purpose such as fitted furniture or carpets. Please tell us if you have any problems and members of our branches will help either over the phone or in person. A copy of our complaints procedure is available on request. The details are issued on the strict understanding that any negotiations in respect of the property named herein are conducted through Aspire Estate Agents.