

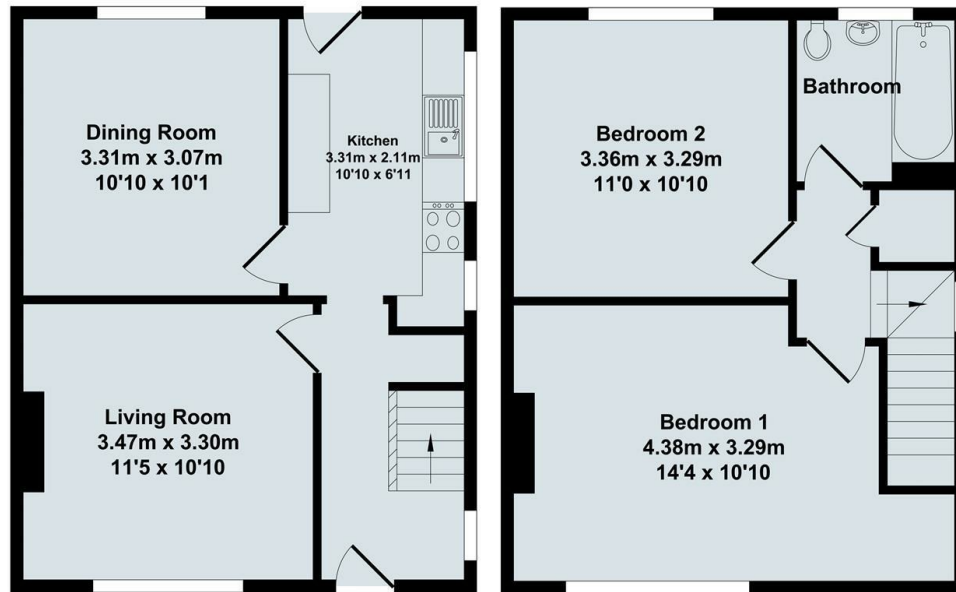

## 26 Grundy Crescent, Kennington, Oxon, OX1 5PS

£1,450 PCM - 4th September 2024.

- 2 Bedroom Semi Detached House
- Central Heating
- Council Tax Band C
- Unfurnished.
- Double Glazed Windows
- Generous Sized Garden with Lovely Decked Area
- EPC Band C



Ground Floor  
Approx. Floor Area  
35.42 Sq.M.  
(381 Sq.Ft.)

First Floor  
Approx. Floor Area  
35.42 Sq.M.  
(381 Sq.Ft.)

Total Approx. Floor Area 70.84 Sq.M. (763 Sq.Ft.)

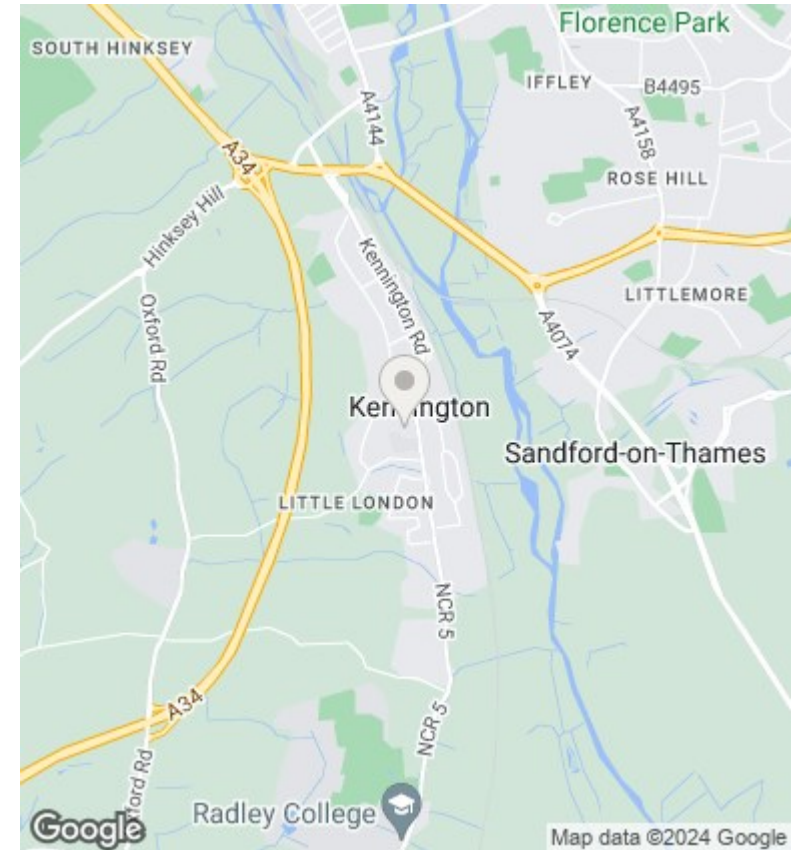

## Directions

## Viewings

Viewings by arrangement only. Call 01235 554950 to make an appointment.

## Council Tax Band

C

## EPC Rating:

Energy Efficiency Rating		
	Current	Potential
<i>Very energy efficient - lower running costs</i>		
(92 plus) <b>A</b>		
(81-91) <b>B</b>		
(69-80) <b>C</b>		
(55-68) <b>D</b>		
(39-54) <b>E</b>		
(21-38) <b>F</b>		
(1-20) <b>G</b>		
<i>Not energy efficient - higher running costs</i>		
<b>England &amp; Wales</b>	EU Directive 2002/91/EC	