

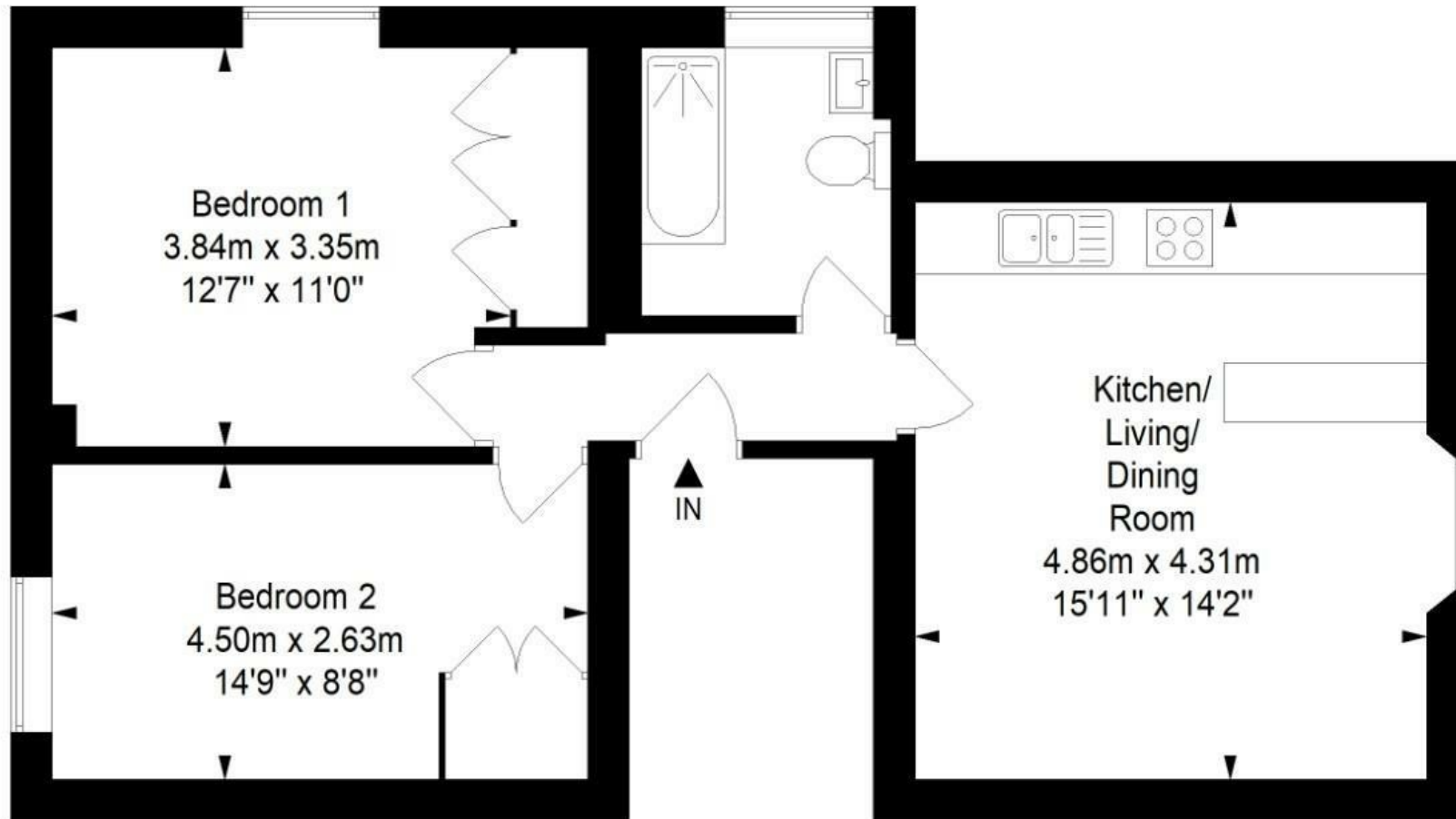

## First Floor Flat, Cotham Brow, Cotham, Bristol, BS6 6AP

Approximate Gross Internal Area = 58.0 sq m/ 624.3 sq ft



**This floor plan has been drawn using RICS guidelines (GIA)**

Disclaimer : Please note this floor plan is for marketing purposes and is to be used as guide only.  
All Efforts have been made to ensure its accuracy at time of print

**Boardwalk**

# Cotham Brow

COTHAM, BRISTOL

£

£335,000



BS6 6AP

zzz

2 Bedrooms



1 Bathrooms

*"We've absolutely loved the lifestyle that Cotham offers – amidst so many green spaces and vibrant independent businesses. It's amazing being a short walk from the wealth of foodie hotspots that Cotham Hill, Chandos Road and Gloucester Road offer, and the greenery of Cotham Gardens and Clifton Down. We've really enjoyed the balance of city life and escapism! The light-filled, open plan living is also perfect for hosting friends. We know the next owners will love it just as much us!"*

