

Birchwood Close

FISHPONDS

APPROXIMATE FLOOR AREA
77.5 SQM / 834 SQFT



GROUND FLOOR

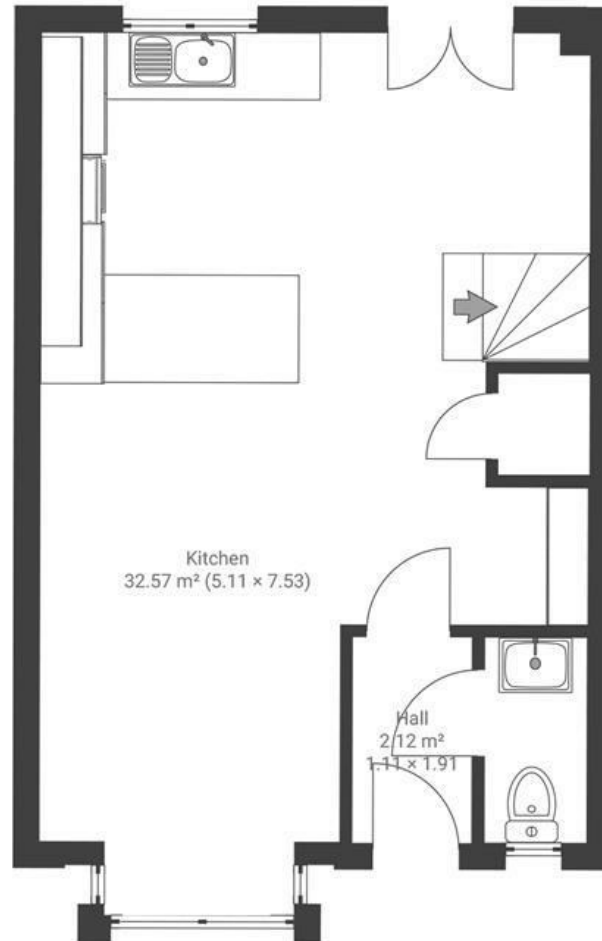

FIRST FLOOR

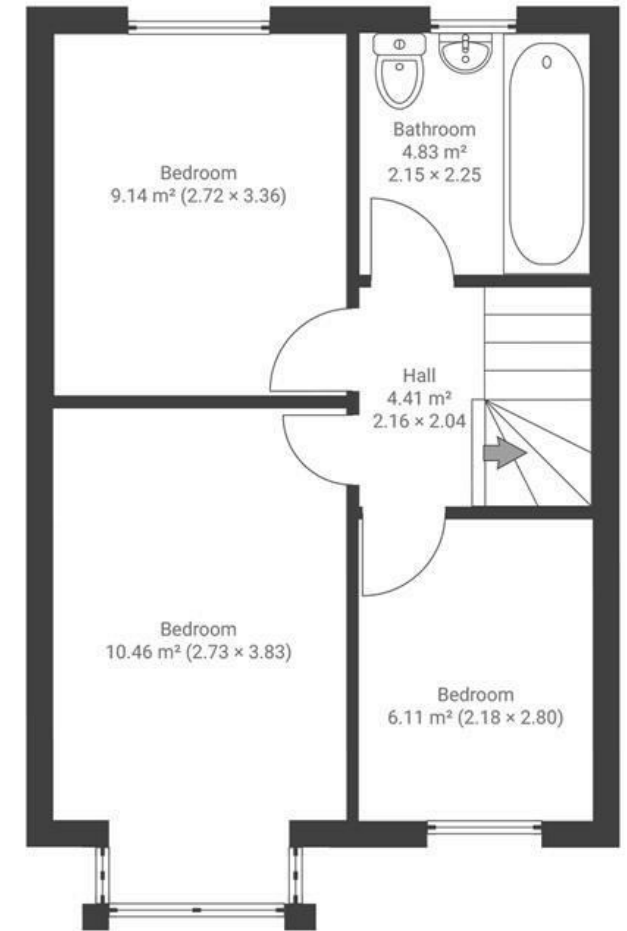

Boardwalk

Birchwood Close

FISHPONDS, BRISTOL



£400,000



3 Bedrooms



Bristol, BS16



2 Bathrooms

5BF



"We love the proximity of the house to both Downend High Street and Fishponds Road with its mix of lively bars, restaurants and quirky cafes. We love the spacious and modern open plan kitchen, especially socialising with friends and family around the breakfast bar. We enjoyed being tucked away from the main road but also being a only couple of minutes away from the 24 hour bus into the city and a short walk from the beautiful Snuff Mills."