

Battersea Road

EASTON

APPROXIMATE FLOOR AREA
99.5 SQM / 1070 SQFT

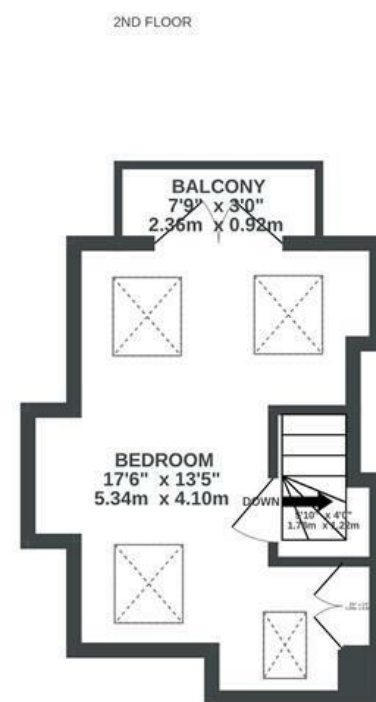
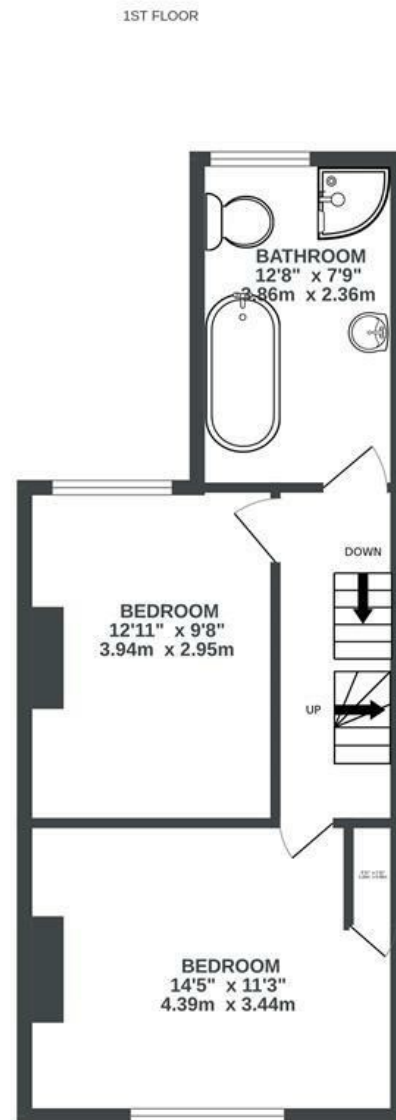
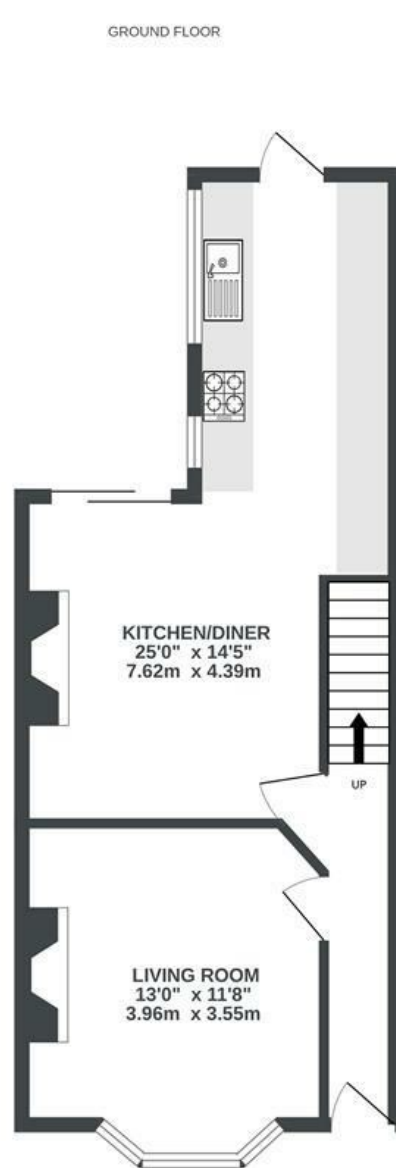

Boardwalk

Battersea Road

EASTON, BRISTOL



£450,000



3 Bedrooms



BS5 6AL



1 Bathrooms

"We love the community where we live, both on the road itself and in the local area. The community centre right next door has a lovely cafe, community events, and a nursery that our kids have loved. The nearby pubs are awesome and are also brilliant community hubs, and we love getting a takeaway tiffin box from the Thali cafe, popping to Sweet Mart, and the great resources for kids like Hawks Gym. There's so much going on right on our doorstep!"

