

Paintworks

ARNOS VALE

APPROXIMATE FLOOR AREA
65 SQM / 700 SQFT



4TH FLOOR
700 sq.ft. (65.0 sq.m.) approx.

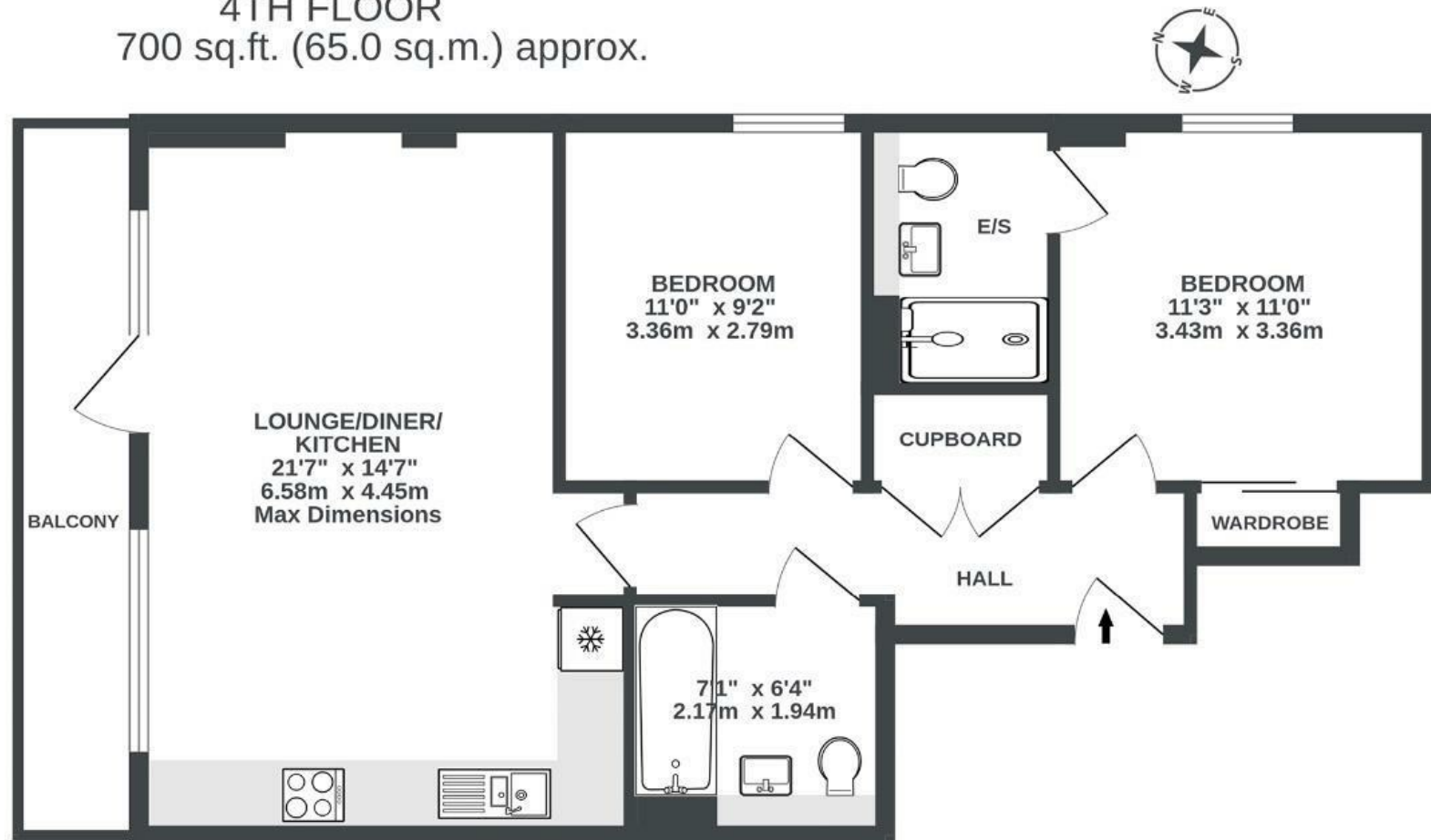

Illustrations are for reference purposes only, measurements are approximate, not to scale.

~~Boardwalk~~

Paintworks

ARNOS VALE, BRISTOL



£305,000



2 Bedrooms



BS4 3AS



2 Bathrooms

"I bought my apartment because of its fantastic location to reach the City Centre. With the balcony overlooking the river it feels extremely peaceful, particularly in the summer when all the leaves come out on the trees"

