

Sturminster Road

STOCKWOOD

APPROXIMATE FLOOR AREA
61.5 SQM / 662 SQFT



GROUND FLOOR

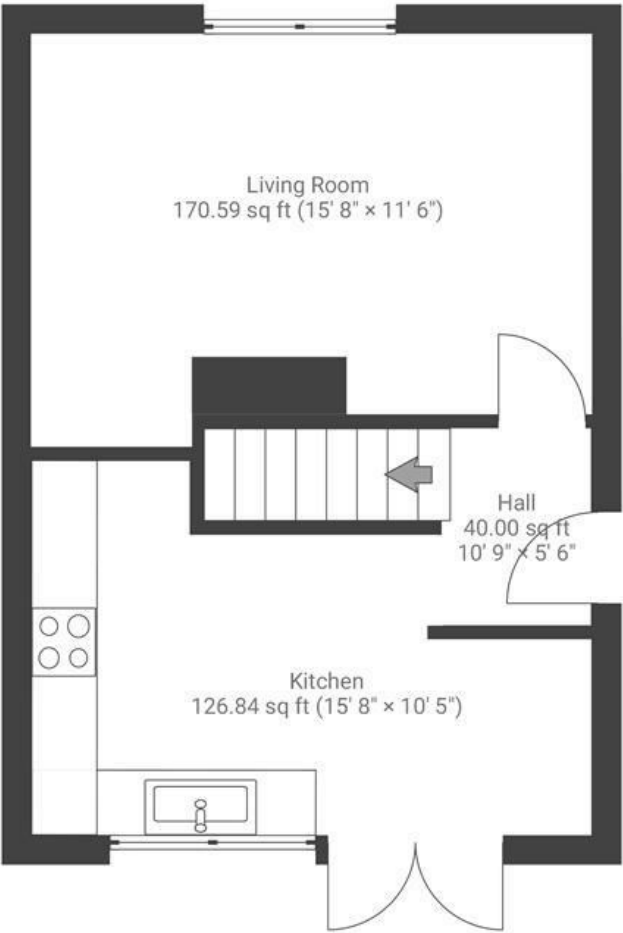

FIRST FLOOR

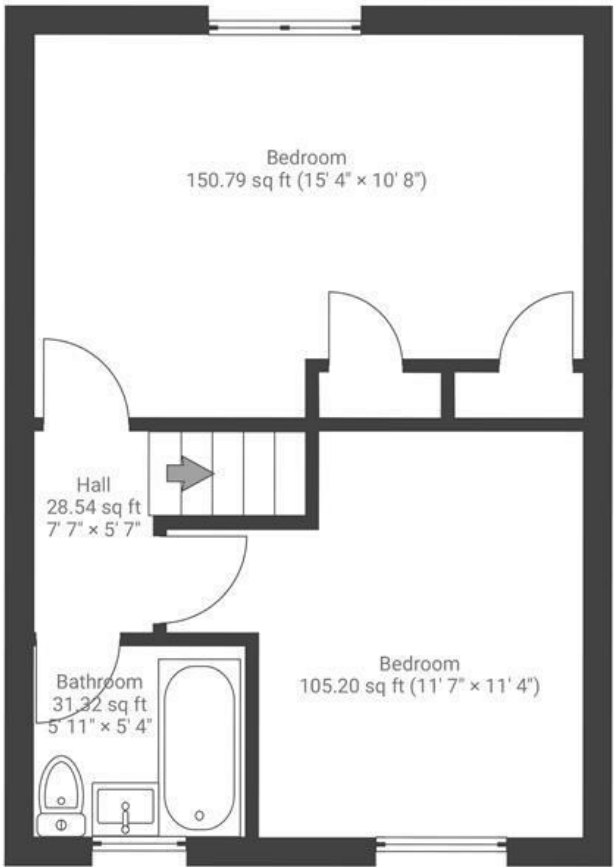

Boardwalk

Sturminster

STOCKWOOD, BRISTOL



£275,000



2 Bedrooms



BS14 8EW



1 Bathrooms

"I've loved living here due to the close proximity to the countryside and two nature reserves just a few minutes' walk away. We've loved the ability to pack up a hamper on a sunny day and either walk or drive to the countryside in a matter of minutes. Bath, Wells, and Glastonbury are easily accessible via bus routes, with a stop right outside our house. The spacious rooms provide plenty of room to live and grow."

