

Kings Gate House

KINGSWOOD

APPROXIMATE FLOOR AREA
52.2 SQM / 562 SQFT

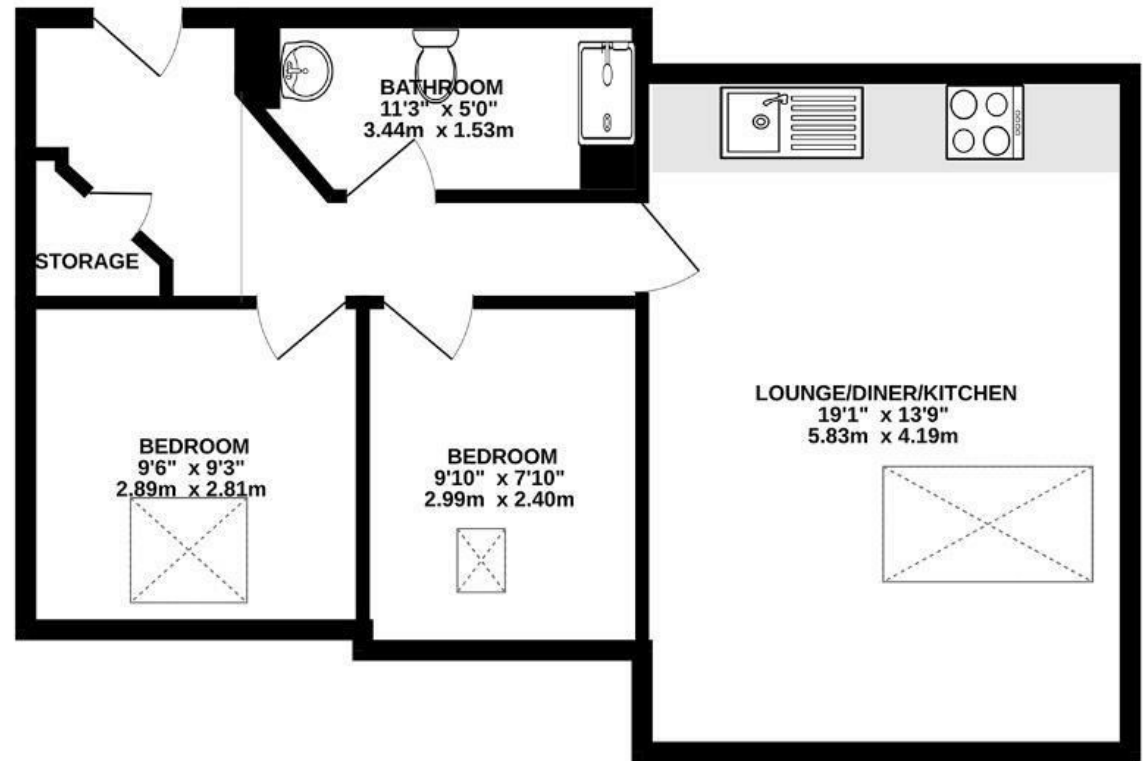

Illustrations are for reference purposes only, measurements are approximate, not to scale.

Boardwalk

Church Road

KINGSWOOD, BRISTOL



£225,000



2 Bedrooms



BS15 4FT



1 Bathrooms

"This is a really friendly building with most of the neighbours having been here since the development was finished. We love the big open living space and high ceilings. The kitchen/lounge/diner is a such a multi-use space enjoyed by the whole family."

