

Lyme Way

KNOWLE

APPROXIMATE FLOOR AREA
87.1 SQM / 937 SQFT



GROUND FLOOR
475 sq.ft. (44.2 sq.m.) approx.

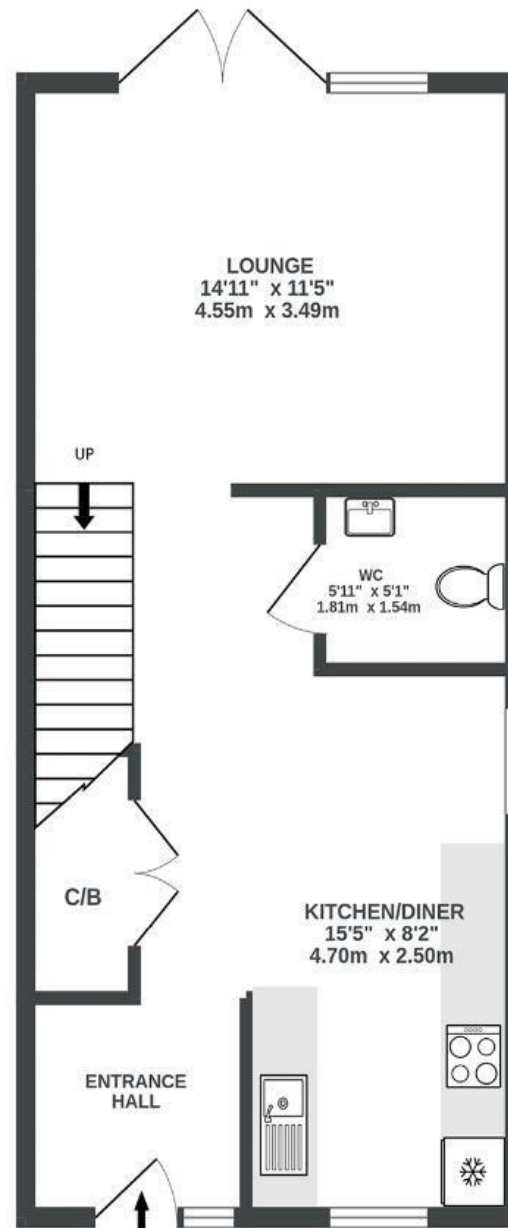

1ST FLOOR
462 sq.ft. (42.9 sq.m.) approx.

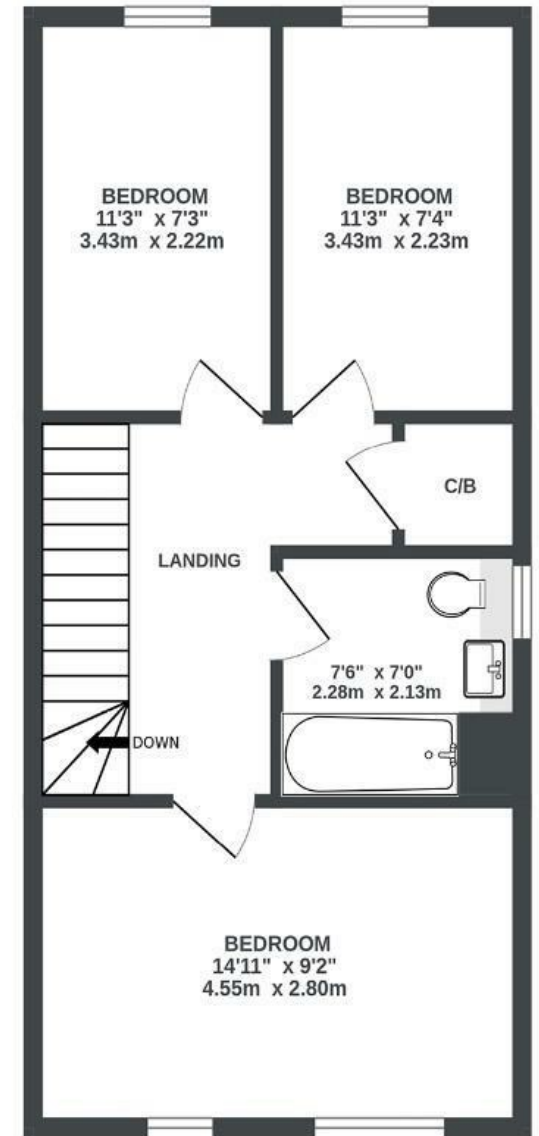

Boardwalk

Lyme Way

KNOWLE, BRISTOL



£360,000



3 Bedrooms



BS4 1FY



2 Bathrooms

"We really enjoy living here. The house has a clean, Scandinavian style — it's eco-friendly, well thought-out, and everything feels solid and built to last. The design just makes sense. There's a great sense of community, our neighbours are friendly, and it feels safe and settled. It's also super convenient — really easy access to central Bristol, and we're right near a beautiful nature reserve, which is a real bonus. It's a place that works for all kinds of people."

