

Haverstock Road

KNOWLE

APPROXIMATE FLOOR AREA
81.1 SQM / 873 SQFT



1ST FLOOR
644 sq.ft. (59.9 sq.m.) approx.



2ND FLOOR
229 sq.ft. (21.3 sq.m.) approx.

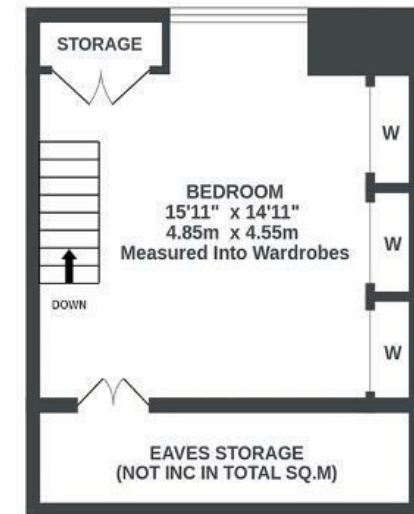

Illustrations are for reference purposes only, measurements are approximate, not to scale.

Boardwalk

Haverstock Road , BRISTOL



£325,000



2 Bedrooms



BS4 2BZ



1 Bathrooms

"There is such a strong welcoming community here, which has been so nice having lived out of the city for several years. Perrett's Park at the end of the road is a real highlight and has some of the best views of the city. It's a lovely quiet street, but it also has some great bars/pubs on Wells Road with the city centre and Bristol Temple Meads being very easily accessible. This was our first home together, so it will always be a special place for us, and I'm sure the next owners will love living here as much as we have."

