

# Gwilliam Street

## WINDMILL HILL

APPROXIMATE FLOOR AREA  
110 SQM / 1184 SQFT



LOWER GROUND FLOOR



GROUND FLOOR

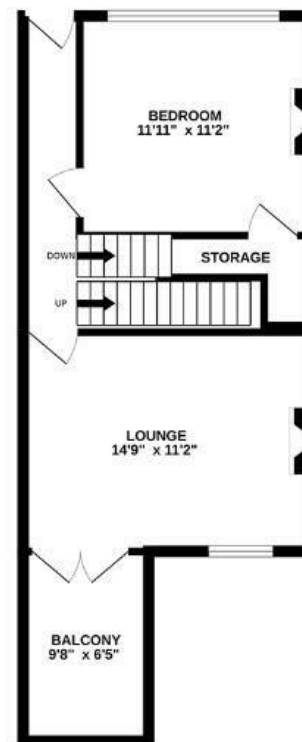

FIRST FLOOR



Boardwalk

# Gwilliam Street , BRISTOL



£500,000



3 Bedrooms



BS3 4LT



2 Bathrooms

*"We have absolutely loved living on Gwilliam Street. Relaxing in the evening sun on our balcony, overlooking Bristol, is one of our favourite parts of living here. We are really spoiled with our location in Windmill Hill. The Victoria Park pub is only a short walk away and has an amazing beer garden. North Street is also within walking distance and we enjoy going for a roast or wandering around the Tobacco Factory market on a Sunday. Since renovating the property, we love spending time in our sociable kitchen that opens out into the garden."*

