

St Lukes Road

VICTORIA PARK

APPROXIMATE FLOOR AREA
39.1 SQM / 421 SQFT



LOWER GROUND FLOOR
421 sq.ft. (39.1 sq.m.) approx.

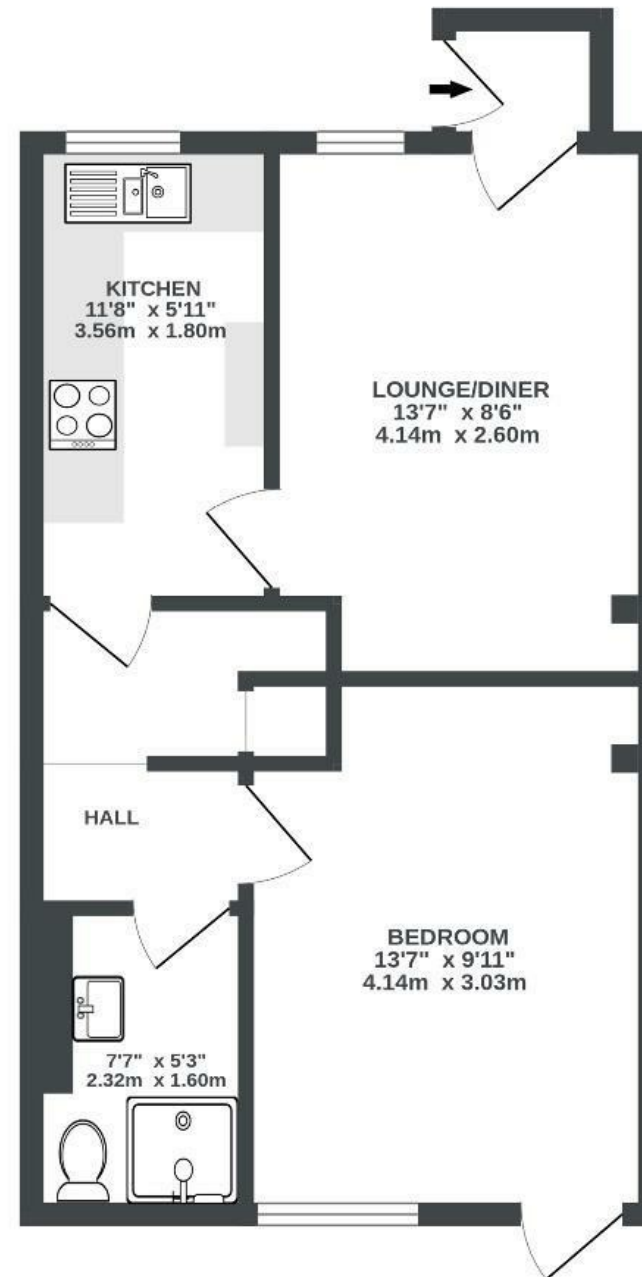

Illustrations are for reference purposes only, measurements are approximate, not to scale.

Boardwalk

St. Lukes Road , BRISTOL

£

£225,000



BS3 4RX

zzz

1 Bedrooms



1 Bathrooms

"We have found our property to be a fabulous quirky flat with a deceptive size layout. From having its own private entrance with courtyard to the front ,to it's enchanting south facing garden to the back, its been a peaceful oasis in the heart of urban life."

