

# Doone Road

## HORFIELD

APPROXIMATE FLOOR AREA  
80.5 SQM / 866 SQFT



GROUND FLOOR  
453 sq.ft. (42.1 sq.m.) approx.

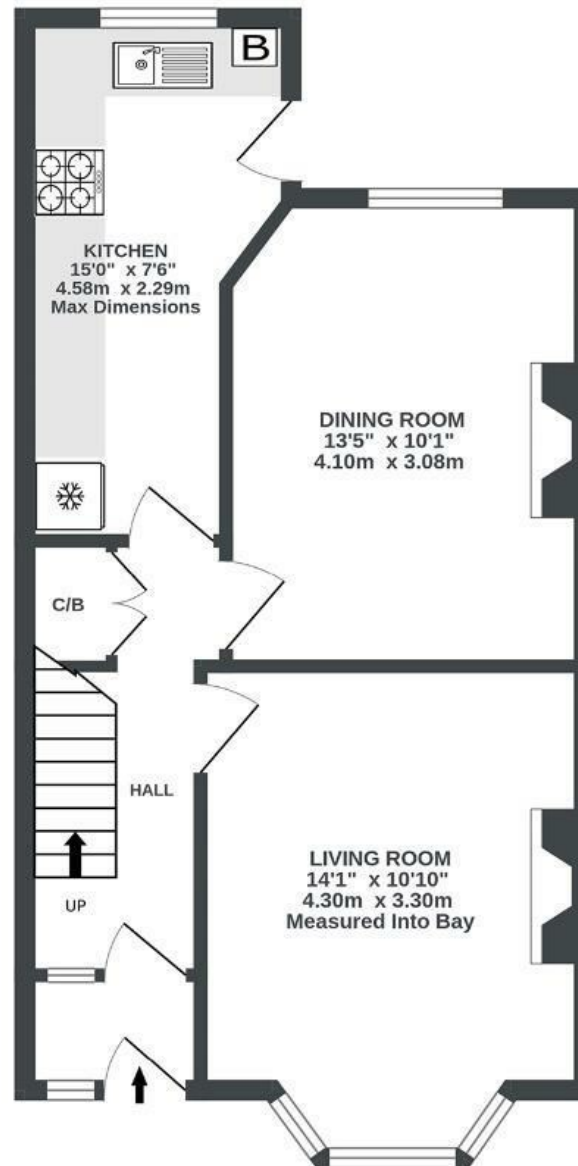

FIRST FLOOR  
413 sq.ft. (38.4 sq.m.) approx.

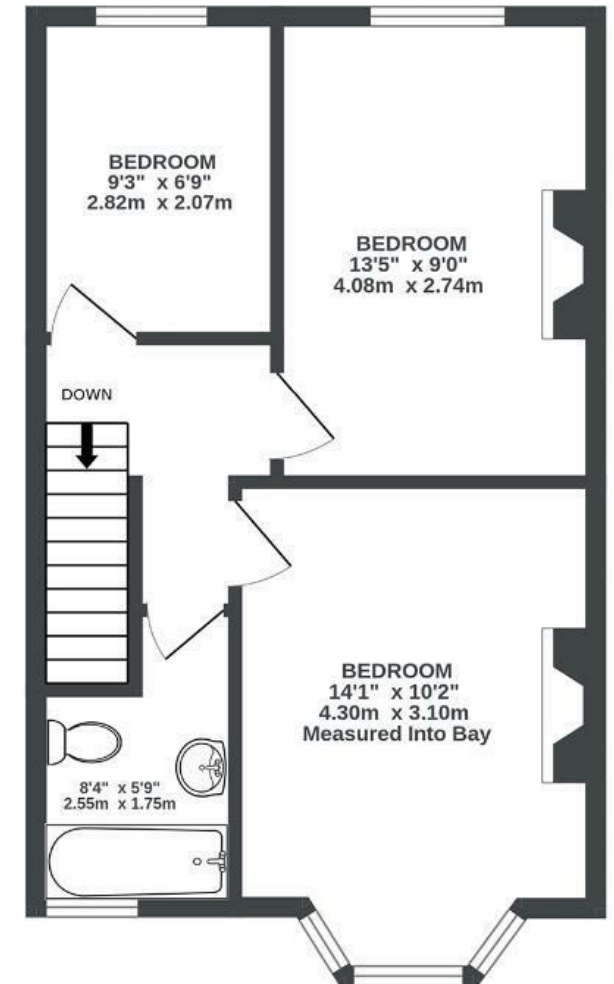

Illustrations are for reference purposes only, measurements are approximate, not to scale.

Boardwalk

# Doone Road

, BRISTOL



£450,000



BS7 0JG



3 Bedrooms



1 Bathrooms

*'We have lived here for seven years, and having met in Bristol, we have made this our family home. We have treasured being in a vibrant, safe, and thriving part of Bristol. It's accessible to all the things we need (work, social, gym, travel outside of Bristol) but acts as our own space away from everything. We enjoy our south facing garden in the spring and summer, but cosy up with a fire in living room in Autumn/Winter.'*

