

# Rownham Mead

## HOTWELLS

APPROXIMATE FLOOR AREA  
134 SQM / 1442 SQFT



Ground Floor



First Floor

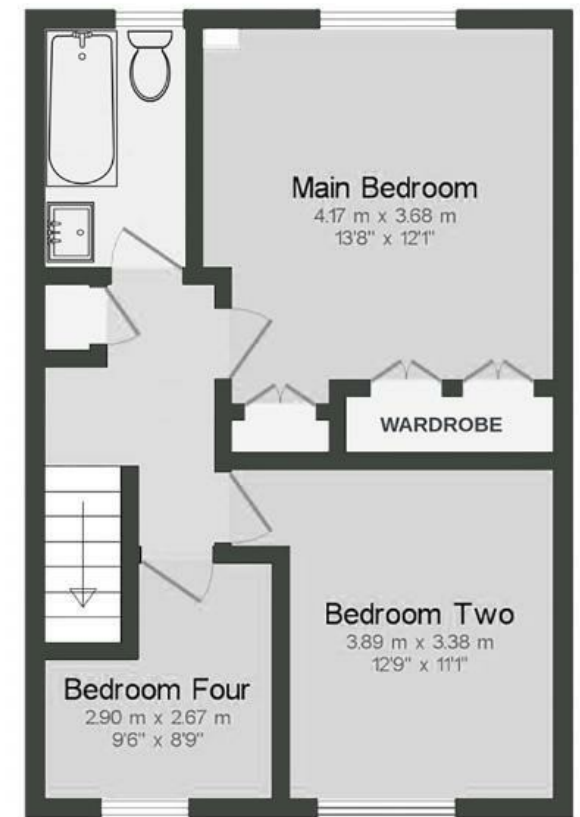

Second Floor

Illustrations are for reference purposes only, measurements are approximate, not to scale.

Boardwalk

# Rownham Mead

, BRISTOL

£

£850,000

zzz

4 Bedrooms



BS8 4YB



2 Bathrooms

*"It's felt such a privilege to live here – the views along the harbour in one direction, and out to Ashton Court in the other, are genuinely iconic. We've loved sitting in the garden early in the morning, watching the geese flying in, and the rowers heading out on the water. The house is quiet and sun-filled, and the location is so central – walking along the waterfront into town in one direction, or up into Clifton in just a few minutes in the other – has been fantastic."*

