

FLAT 2, THE CIGAR FACTORY SOUTHVILLE

APPROXIMATE FLOOR AREA
44.5 SQM / 480 SQFT

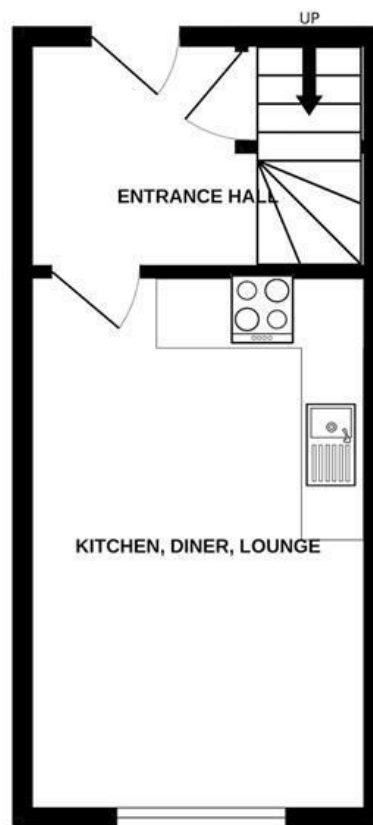

GROUND FLOOR
222 sq.ft. (20.6 sq.m.) approx.



1ST FLOOR
258 sq.ft. (23.9 sq.m.) approx.

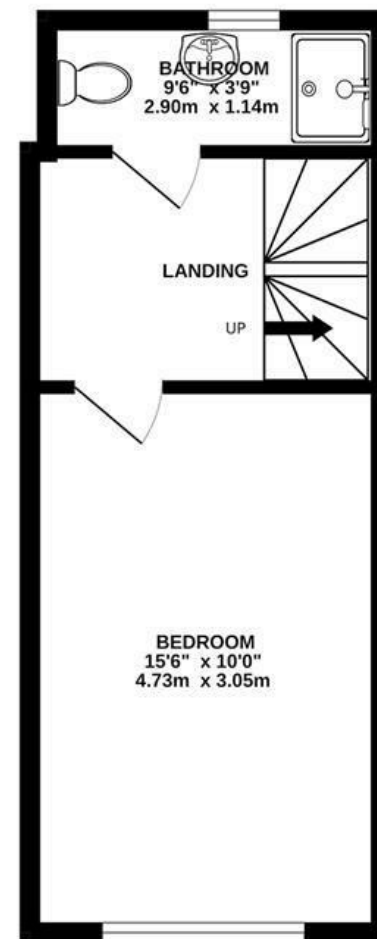

Boardwalk

Raleigh Road , BRISTOL



£240,000



1 Bedrooms



BS3 1QU



1 Bathrooms

"Everything you need is on the doorstep. I like the Tobacco Factory market on a Sunday which is right outside. I like the view of the suspension bridge. All of the restaurants on North Street take two minutes to walk to and having Aldi right opposite saves a lot of money and time. It is also very easy to walk into Ashton Court and Whapping Wharf."

