

Boardwalk

Wingfield Road

KNOWLE, BRISTOL

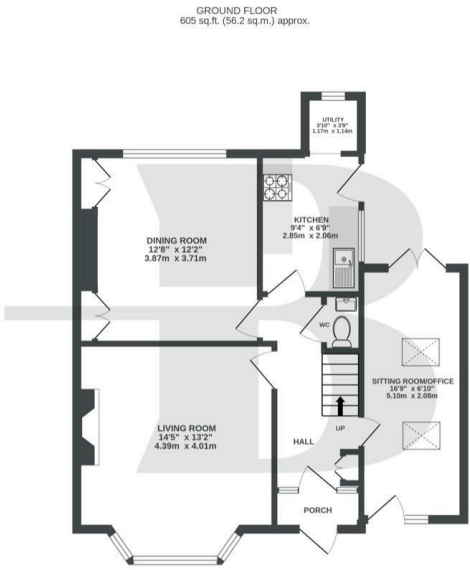
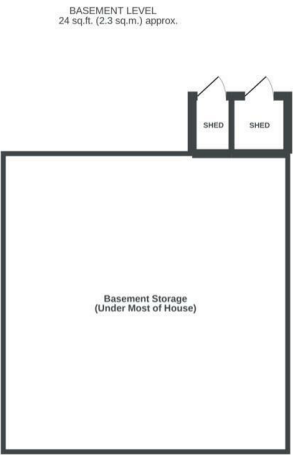

TOTAL FLOOR AREA : 1101 sq.ft. (102.3 sq.m.) approx.

Whilst every attempt has been made to ensure the accuracy of the floorplan contained here, measurements of doors, windows, rooms and any other items are approximate and no responsibility is taken for any error, omission or mis-statement. This plan is for illustrative purposes only and should be used as such by any prospective purchaser. The services, systems and appliances shown have not been tested and no guarantee as to their operability or efficiency can be given.

Made with Metropix ©2022



Boardwalk

Wingfield Road

KNOWLE, BRISTOL



£500,000



BS3 5EH



3 Bedrooms



2 Bathrooms

"This place has been my home and my security for many years; the warmth and strength of the community here is second to none. My most powerful memories will be of the amazing, dramatic, and ever-changing view of sky from the expansive windows. Every moment has displayed a different picture, from deep dark navy star filled night skies, through to magnificent fire lit blazing red summer evening sunset scenes. The light and space from the far-reaching views has not only inspired and overawed me but also gifted me with a connection to something far greater than myself, throughout the 24 years of my adult life that I have loved and adored living in this beautiful house. I have been honoured and blessed to have it as part of my life"

