

Brick Kiln Court

EASTON

APPROXIMATE FLOOR AREA
110 SQM / 1184 SQFT



GROUND FLOOR
438 sq.ft. (40.7 sq.m.) approx.

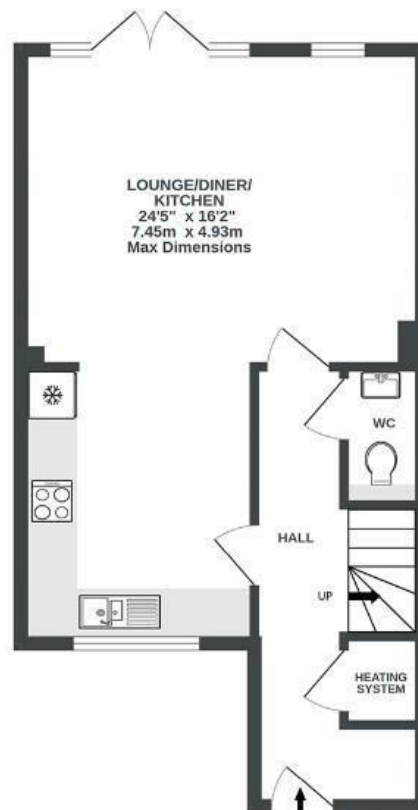

1ST FLOOR
459 sq.ft. (42.6 sq.m.) approx.



2ND FLOOR
287 sq.ft. (26.7 sq.m.) approx.



Illustrations are for reference purposes only, measurements are approximate, not to scale.

Boardwalk

Brick Kiln Court

EASTON, BRISTOL



£425,000



4 Bedrooms



BS5 OFF



2 Bathrooms

"Brick Kiln Court has been an amazing first home for us! We have loved being so close to the city centre whilst having the luxury of our own driveway and outdoor spaces. The open plan living space has been perfect for entertaining friends and family and we will never forget watching the fireworks across the city from our rooftop balcony on New Years Eve. We will really miss being within walking distance of St Marks Road, the east Bristol brewery trail and countless other BS5 gems!"

