

Forest Road

FISHPONDS

APPROXIMATE FLOOR AREA
69 SQM / 743 SQFT

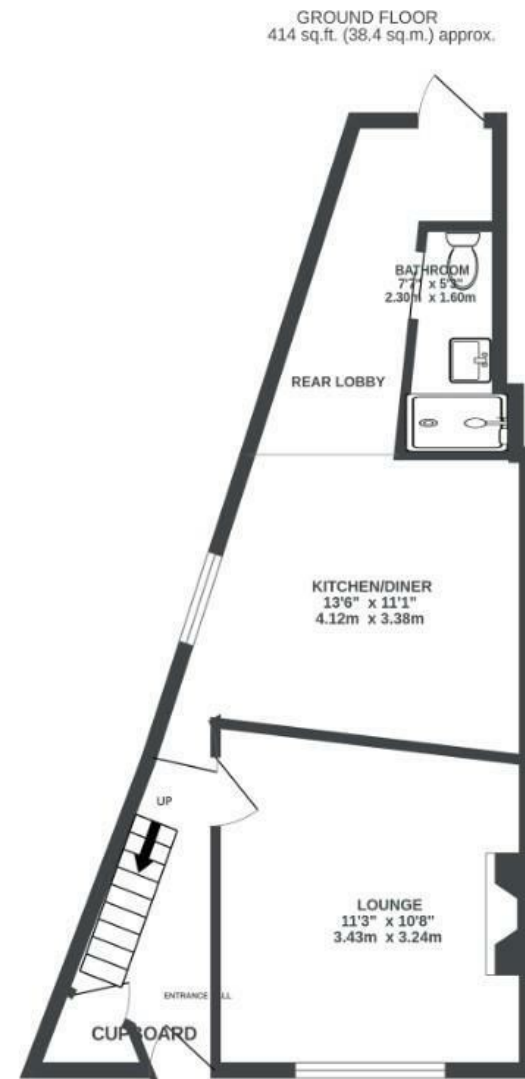

Illustrations are for reference purposes only, measurements are approximate, not to scale.

Boardwalk

Forest Road

FISHPONDS, BRISTOL



£315,000



2 Bedrooms



BS16 3SN



1 Bathrooms

"We love the quirky nature and low maintenance of our home. We also love the location in the up and coming Fishponds area. We love walking to the high street with our dog, grabbing a coffee or breakfast at Fed/crafty egg and getting Apollo treats from the pet shop. We also love at Christmas walking from Downend to Staple Hill and back down to Fishponds stopping at all the local pubs for drinks and food!"

