

Casson Drive

STAPLETON

APPROXIMATE FLOOR AREA
82 SQM / 882 SQFT

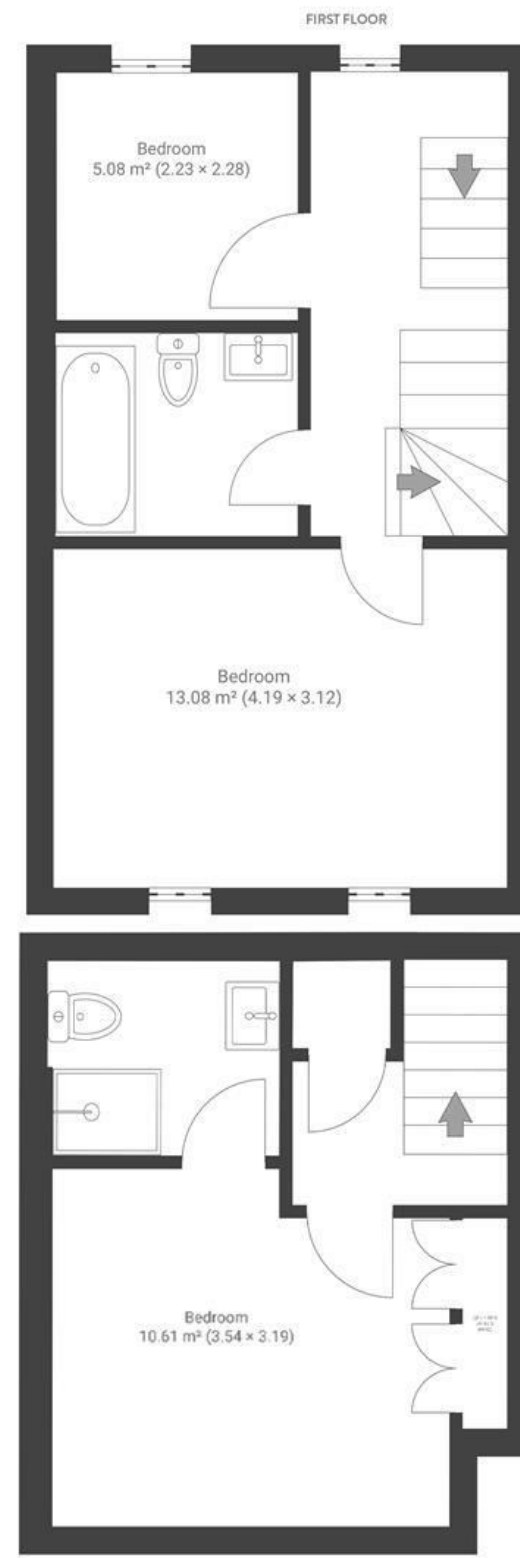
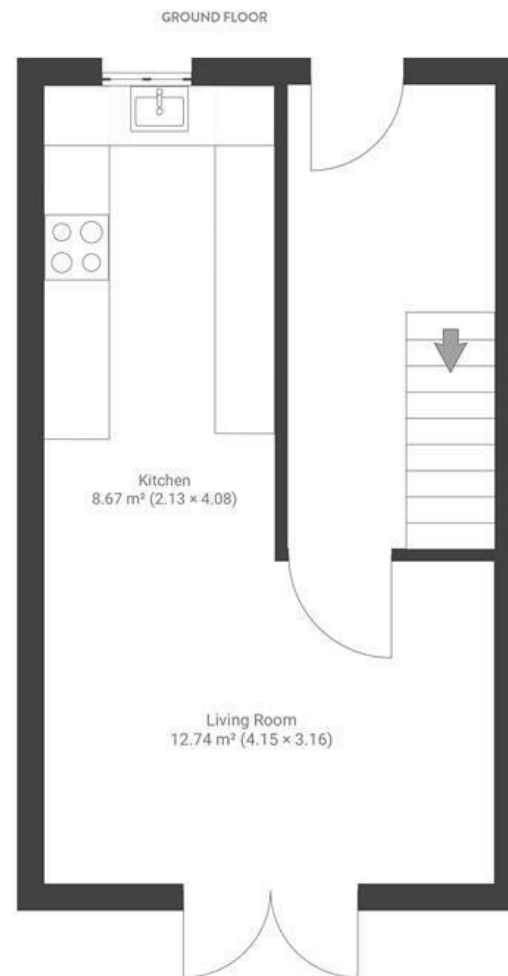

Boardwalk

Casson Drive

, STAPLETON



£375,000



3 Bedrooms



BS16 1WR



2 Bathrooms

'The location of this house was hugely appealing when we bought this home, being able to walk for miles in green space which begins just beyond the front door'

