

# Boswell Street

## EASTVILLE

APPROXIMATE FLOOR AREA  
88.3 SQM / 951 SQFT



GROUND FLOOR  
531 sq.ft. (49.4 sq.m.) approx.

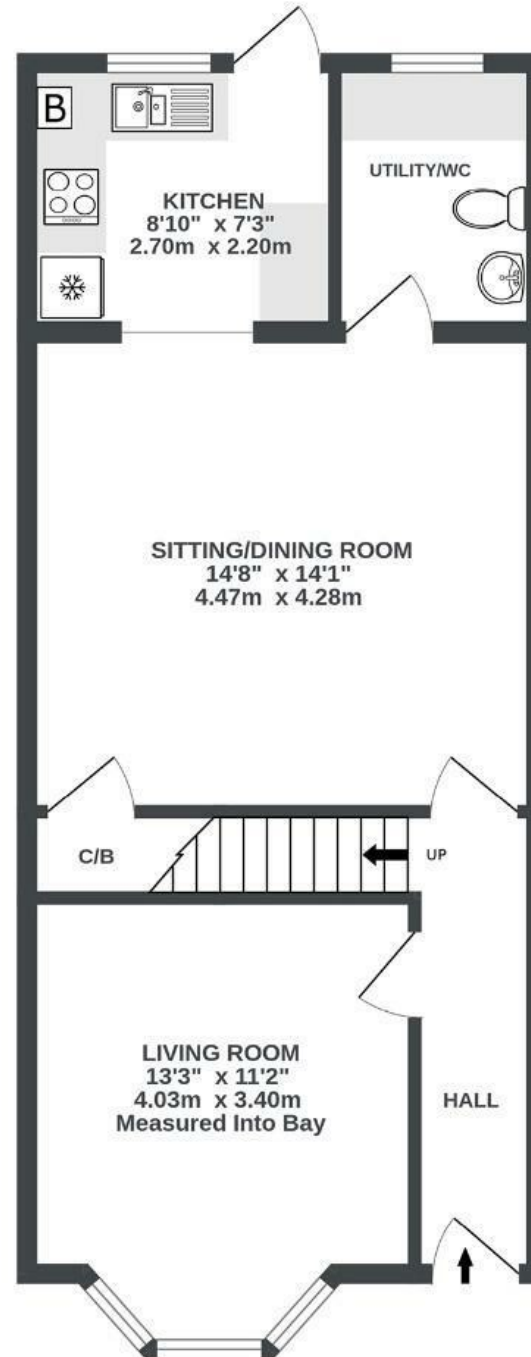

1ST FLOOR  
420 sq.ft. (39.0 sq.m.) approx.

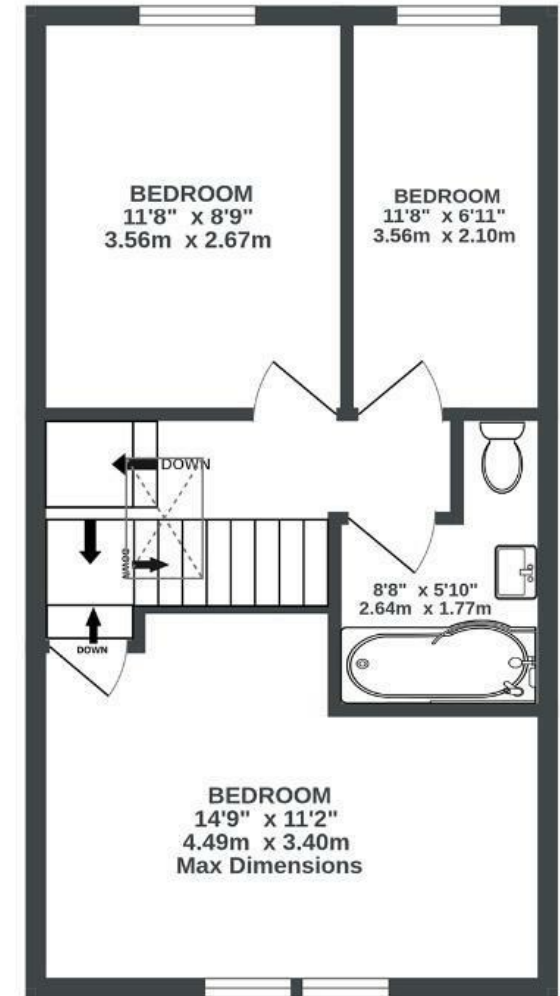

Illustrations are for reference purposes only, measurements are approximate, not to scale.

**Boardwalk**

# Boswell Street

, BRISTOL



£350,000



3 Bedrooms



BS5 6SG



2 Bathrooms

*"The house has given us an amazing space to bring up our young children. It's a short walk to Eastville Park and from there you can forget you're in a city as go along the river Frome to Snuff Mills and beyond. It's a really vibrant area with lots of amazing cafes and pubs like the Garden of Easton, The Greenbank and Sugarloaf. We've got to know our neighbours on what is a friendly road. The garden gets a lot of sun and will provide us with all the raspberries we can eat throughout the year!"*

