

Hardy Road

BEDMINSTER

APPROXIMATE FLOOR AREA
95.5 SQM / 1028 SQFT



GROUND FLOOR
462 sq.ft. (42.9 sq.m.) approx.

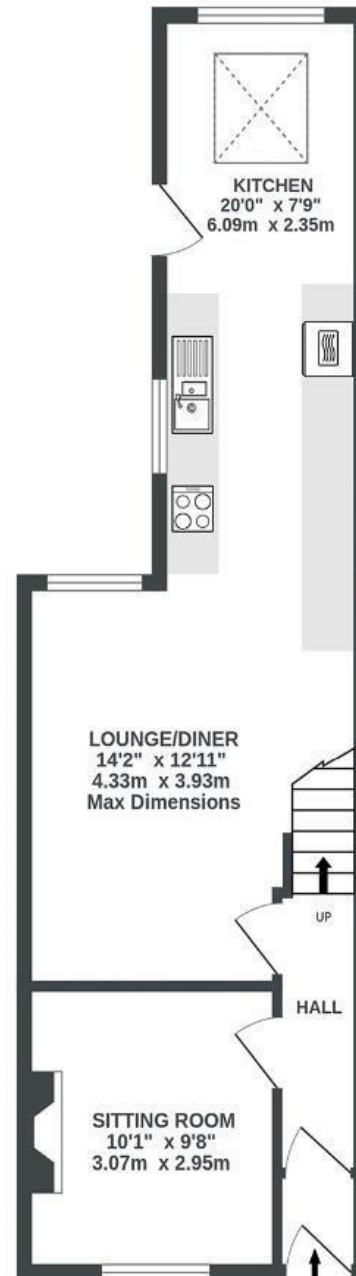

1ST FLOOR
380 sq.ft. (35.3 sq.m.) approx.

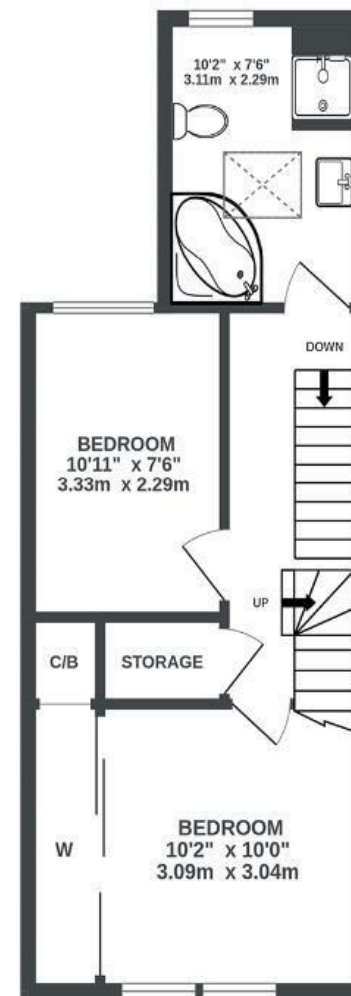

2ND FLOOR
185 sq.ft. (17.2 sq.m.) approx.

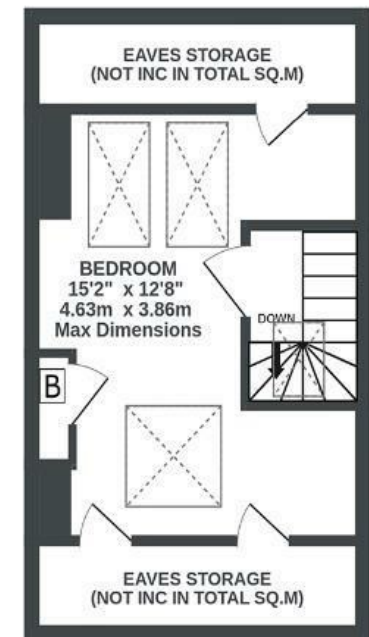

Illustrations are for reference purposes only, measurements are approximate, not to scale.

Boardwalk

Hardy Road , BRISTOL



£395,000



3 Bedrooms



BS3 2SN



1 Bathrooms

"We've been here living happily, raising a family since the late 90s. The home is in one of the three streets that makes up Bristol's first Home Zone. There is a strong sense of community here. Our children went to the local primary schools and secondary and thrived. As our family grew we made a bedroom in the loft and built the kitchen extension. There is space enough for both of us to work from home and for our grown children to come back to visit. The garden is a sun trap, especially in the summer, where we and our dog have spent many hours gardening and soaking up the rays. It's been a great starting for many a walking adventure. The best of urban Bristol and the surrounding countryside."

