

Bishopsworth Road

BISHOPSWORTH

APPROXIMATE FLOOR AREA
124 SQM / 1335 SQFT



GROUND FLOOR

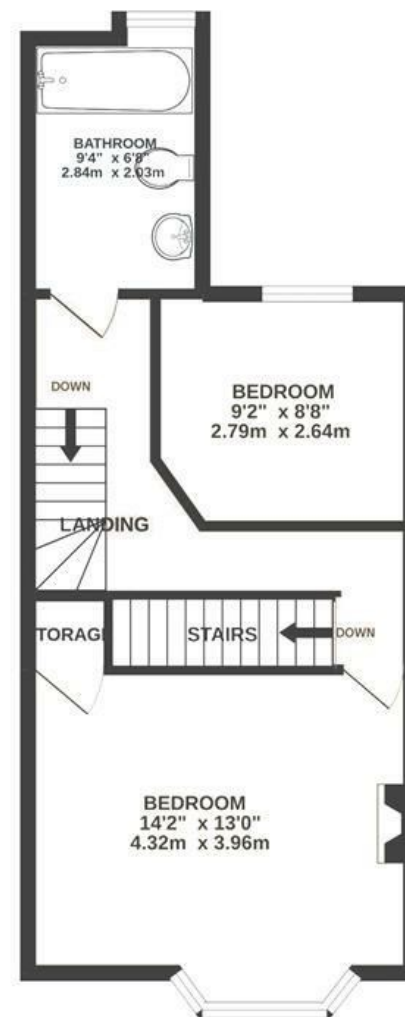

FIRST FLOOR



SECOND FLOOR

Boardwalk

Bishopsworth

, BRISTOL



£450,000



4 Bedrooms



BS13 7JR



3 Bathrooms

"We have loved starting our family here; from the parties in the kitchen to the long sunny summer days in the garden. With two working-from-home parents and a young child, we've spent a huge amount of very comfortable time in the house, enjoying its warmth in the winter and coolness in the summer, spacious rooms, and one-minute access to shops. As we now need to move due to family needs, we'll look back fondly on our first home and know it will take good care of whoever lives here next."

