

# St John's Lane

## BEDMINSTER

APPROXIMATE FLOOR AREA  
75 SQM / 817 SQFT

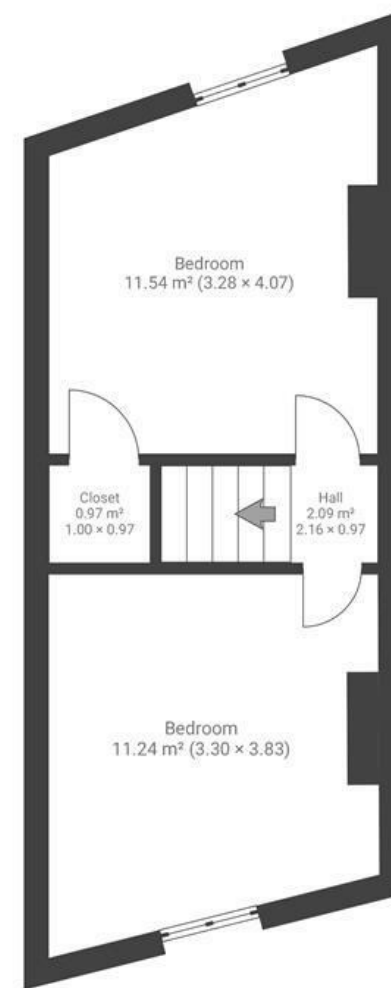

**Boardwalk**

# St. Johns Lane , BRISTOL

---

£

£365,000



BS3 5AA

zzz

3 Bedrooms



1 Bathrooms

---

*"Cooking dinner on a summer evening with the sun shining through the French doors; sipping drinks on the balcony, looking out over the gardens; twice daily walks in the park - there's so many reasons to love this spot. Being a 10 minute walk from Temple Meads, 5 minute cycle from the harbourside and 30 seconds from the best park in Bristol, I think this is surely the most underrated location in the city? After 9 years we're moving on but when we (inevitably) move back, this is where we'll come."*

