

# Muller Road

## HORFIELD

APPROXIMATE FLOOR AREA  
107.6 SQM / 1158 SQFT

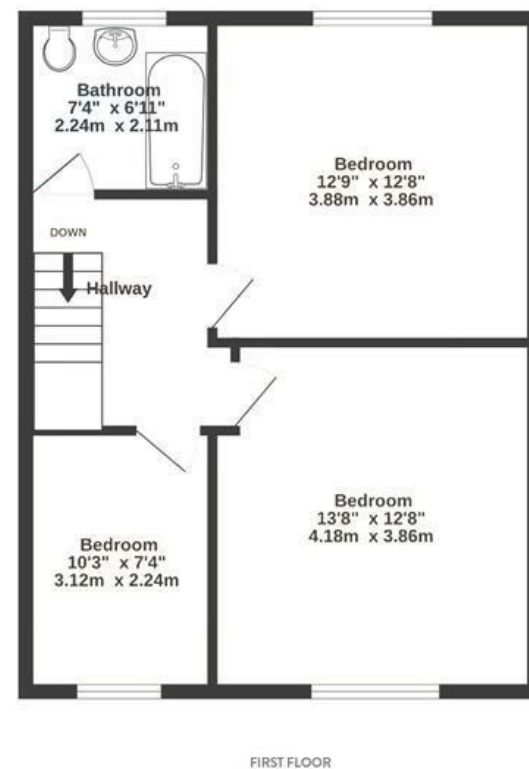
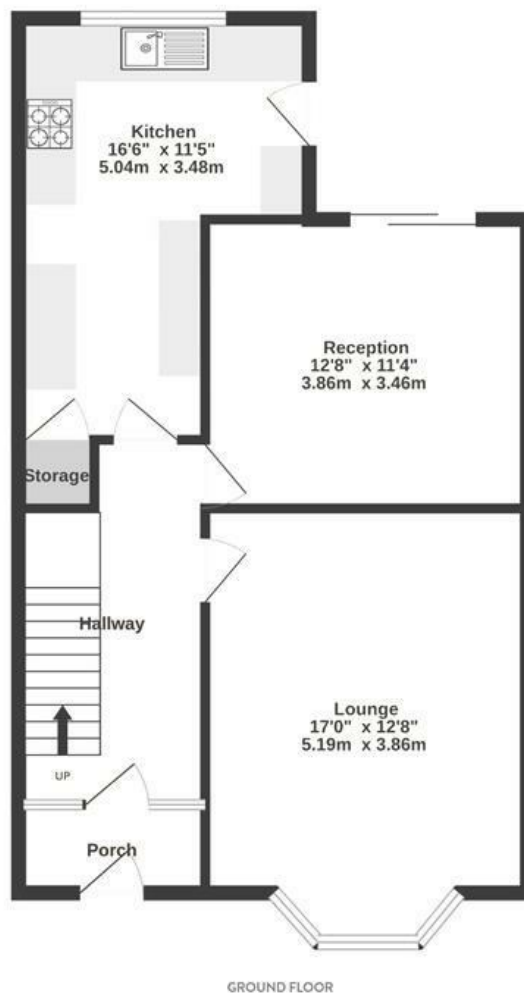

**Boardwalk**

# Muller Road

HORFIELD, BRISTOL



£400,000



3 Bedrooms



BS7 9RH



1 Bathrooms

*"This house has some really lovely original period features, such as the bay window in our living room which provides a lot of light. We have enjoyed the benefits of our large outside space, with al fresco lunches on the patio. We also planted two apple trees two years ago which are now just coming into bloom. A brand new train station just opened down the road 'Ashley Down' The incredibly popular new Japanese listening café 'Lonely mouth' also just opened on the Gloucester Road."*

