

Bryants Hill

HANHAM

APPROXIMATE FLOOR AREA
94.4 SQM / 1016 SQFT



GROUND FLOOR
436 sq.ft. (40.5 sq.m.) approx.

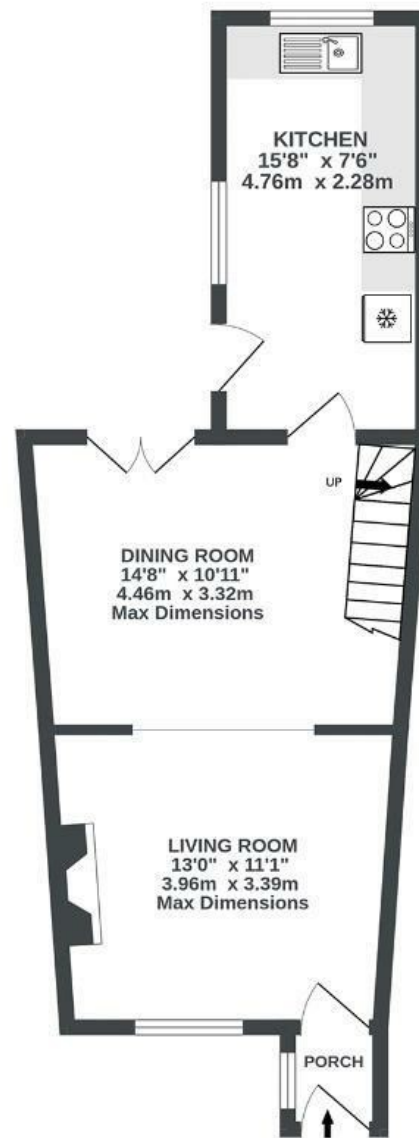

1ST FLOOR
361 sq.ft. (33.5 sq.m.) approx.

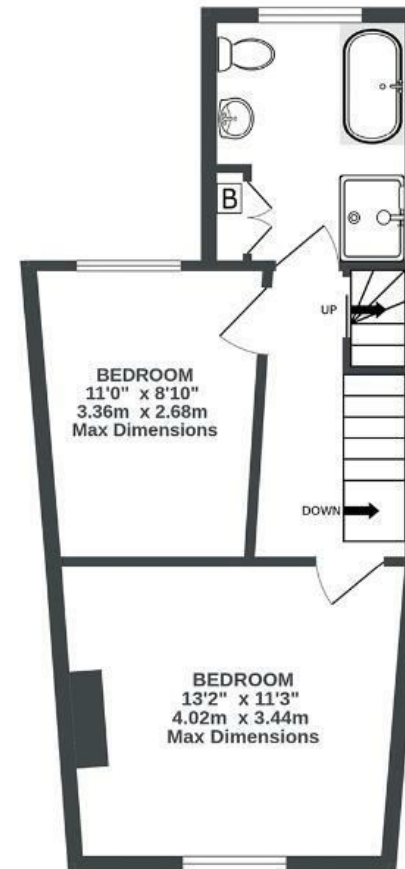

2ND FLOOR
220 sq.ft. (20.4 sq.m.) approx.

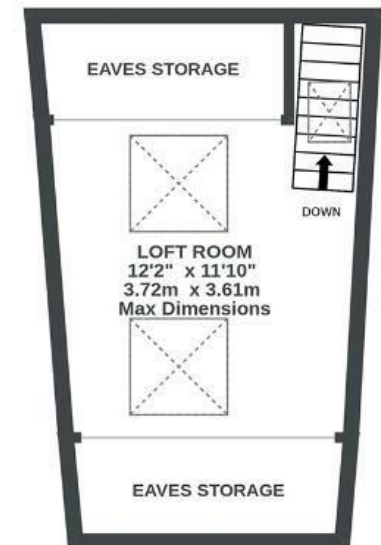

Illustrations are for reference purposes only, measurements are approximate, not to scale.

Boardwalk

Bryants Hill

TROOPERS HILL, BRISTOL



£350,000



2 Bedrooms



BS5 8RG



1 Bathrooms

"When we finally found our lovely St George home, we couldn't believe our luck. It had everything we'd been searching for and more – a cozy cottage feel, right in the heart of one of the city's friendliest communities. It has its own secluded garden oasis, which even comes with a built-in pizza oven, and you can enjoy a peaceful morning coffee. This was a beloved family home, which we eco-renovated and decorated over the happy years we spent there. We will dearly miss this very special place – and just know the next lucky owner will fall in love with it exactly as we did!"

