

Walton Rise

WESTBURY-ON-TRYM

APPROXIMATE FLOOR AREA
88.5 SQM / 953 SQFT



GROUND FLOOR

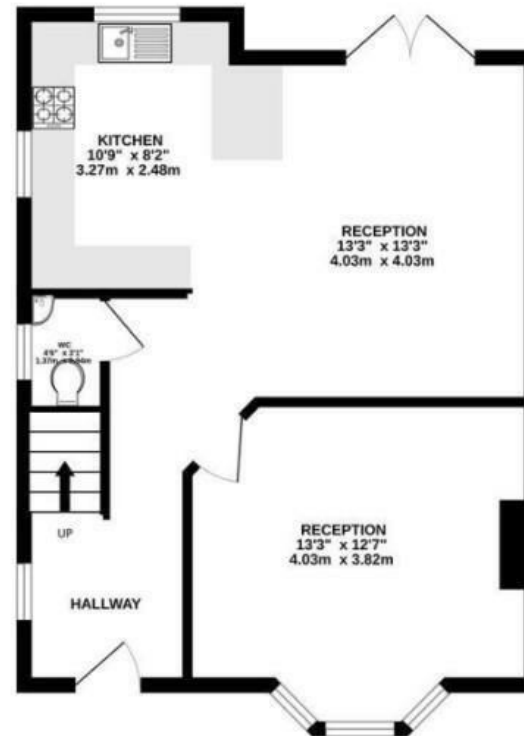

FIRST FLOOR

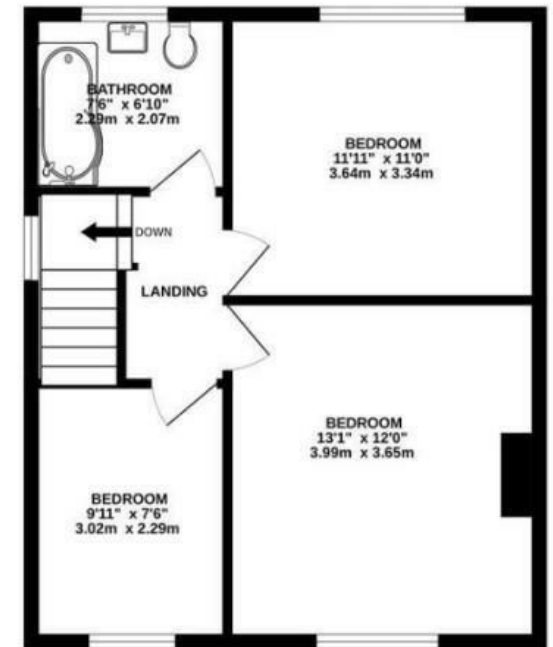

Boardwalk

Walton Rise

, BRISTOL

£

£585,000

zzz

3 Bedrooms



BS9 3EW



1 Bathrooms

“We have completely refurbished this house from top to bottom; it’s a great spot and we hope the new owners enjoy living here”

