

Armidale Place

MONTPELLIER

APPROXIMATE FLOOR AREA
43.0 SQM / 462 SQFT



SECOND FLOOR

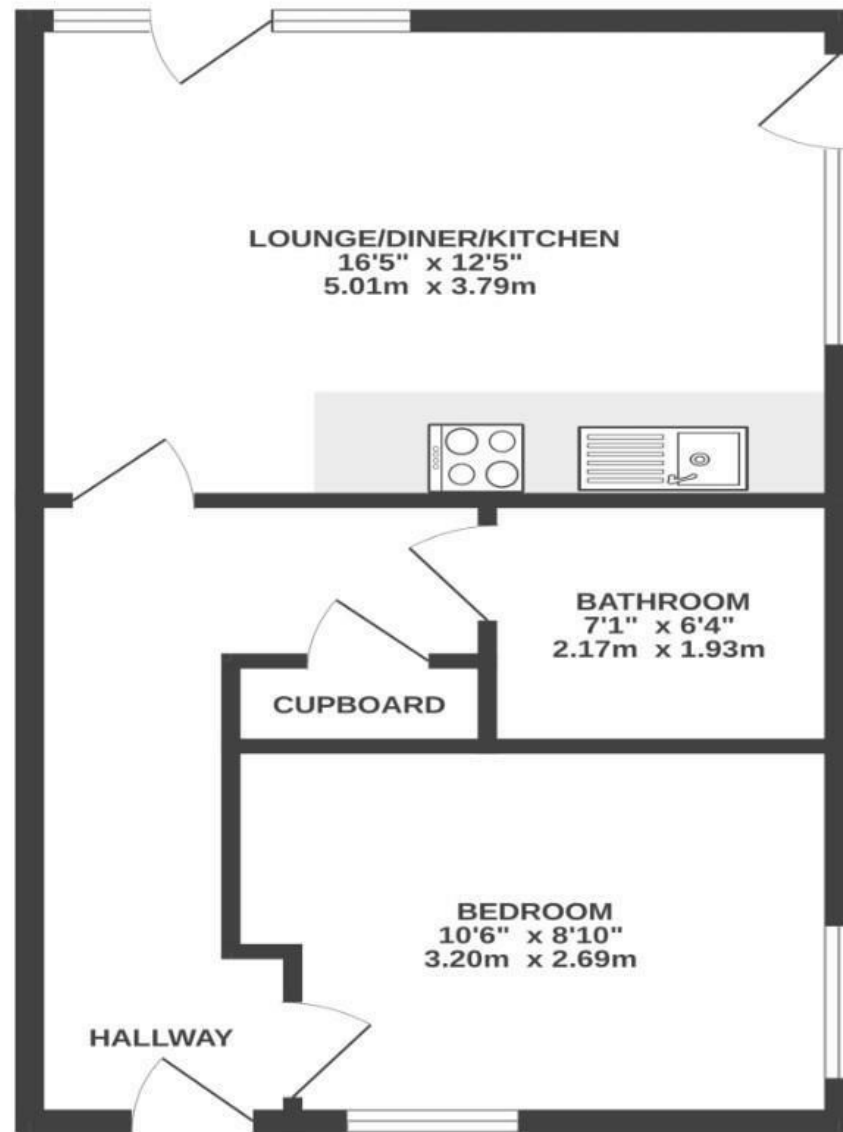

Illustrations are for reference purposes only, measurements are approximate, not to scale.

Boardwalk

Armidale Place

, BRISTOL

£

£190,000

zzz

1 Bedrooms



BS6 5BQ



1 Bathrooms

"Living at Armidale Place has been an absolute joy. The flat is very low maintenance and incredibly energy-efficient – it's so well insulated that I've rarely needed to put the heating on. It's full of natural light throughout the day, especially with the two Juliet balconies. In summer, I love opening them wide, enjoying a book in the sun, and watching the local cats wander across the rooftops. It's been such a peaceful and happy home."

