

Cave Court

ST PAULS

APPROXIMATE FLOOR AREA
68.1 SQM / 733 SQFT



GROUND FLOOR
733 sq.ft. (68.1 sq.m.) approx.

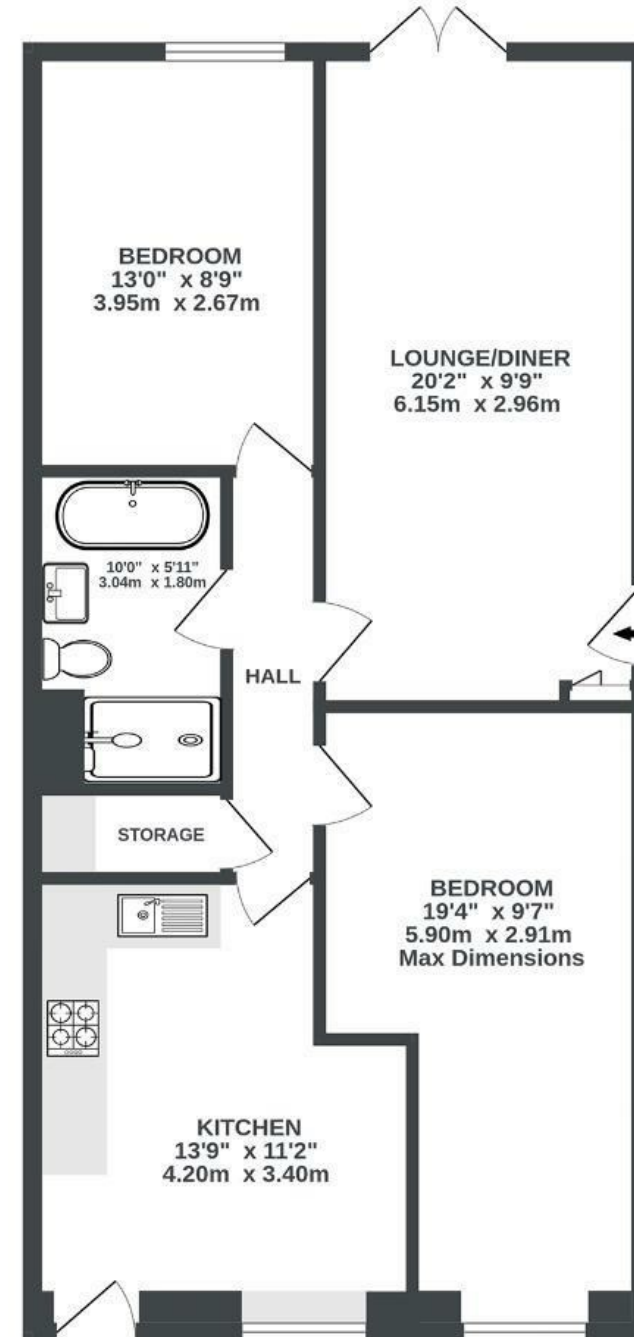

Illustrations are for reference purposes only, measurements are approximate, not to scale.

~~Boardwalk~~

Cave Court,

,

£

£350,000

zzz

2 Bedrooms



BS2 8QZ



1 Bathrooms

"I absolutely loved living in Cave Court, the courtyard feels like a little secluded slice of privacy in the hustle and bustle of St Pauls. The proximity to Montpelier and Stokes Craft meant always having great food and great times a short walk away. With the Thali Cafe, The Crafty Egg and The Bristolian all being within a couple of minutes. Sitting by the front windows of the flat, watching the world go by in Portland Square always made me feel part of the vibrant community that exists."

