

Clouds Hill Avenue

ST GEORGE

APPROXIMATE FLOOR AREA
81 SQM / 872 SQFT



GROUND FLOOR
436 sq.ft. (40.5 sq.m.) approx.

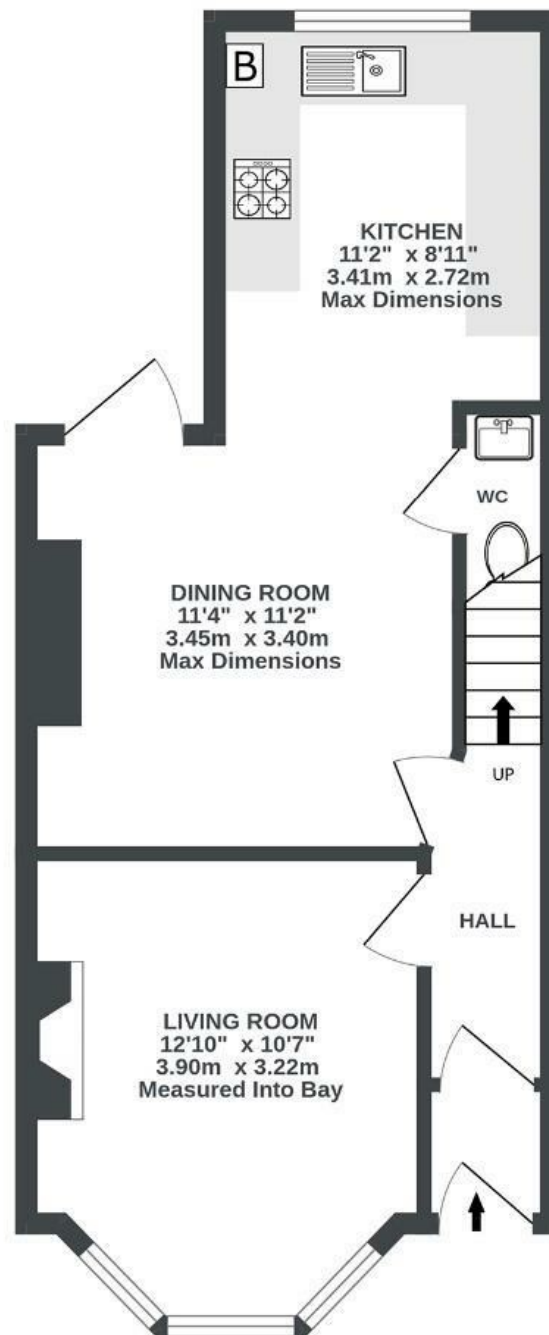

1ST FLOOR
436 sq.ft. (40.5 sq.m.) approx.



Illustrations are for reference purposes only, measurements are approximate, not to scale.

Boardwalk

Clouds Hill

ST GEORGE, BRISTOL



£425,000



3 Bedrooms



BS5 7JE



2 Bathrooms

"The outlook onto the park is truly special, and unlike nothing anywhere else in the city. This is perfect for buyers who want to be within touching distance to nature."

