

Richmond Road

MONTPELIER

APPROXIMATE FLOOR AREA
185.9 SQM / 2001 SQFT

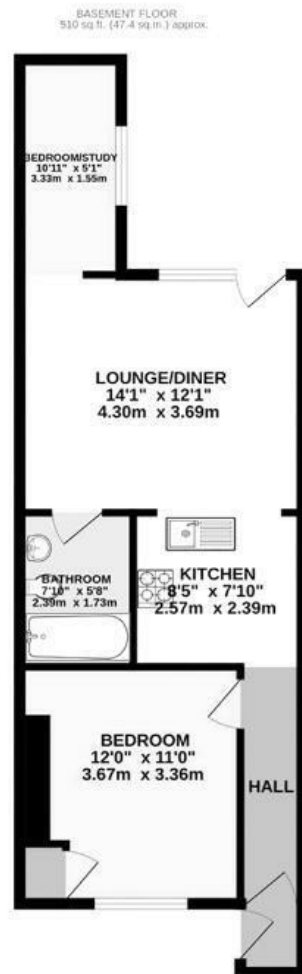

Illustrations are for reference purposes only, measurements are approximate, not to scale.

Boardwalk

Richmond Road

MONTPELIER, BRISTOL

£

£900,000



BS6 5EP

zzz

5 Bedrooms



3 Bathrooms

"The house has been a very happy home, the neighbourhood friendly & peaceful, with a great sense of village community. Montpelier is a lively, bustling, liberal and progressive centre with its colourful independent, quirky cafés, shops and restaurants. Nearby you have the alternative Stokes Croft and Gloucester Road to enjoy, two great areas with a terrific ambiance. But after 27 years it's now time for me to move on...I shall miss it!"

