

Nutgrove Avenue

VICTORIA PARK

APPROXIMATE FLOOR AREA
144.1 SQM / 1552 SQFT



GROUND FLOOR
752 sq.ft. (69.8 sq.m.) approx.

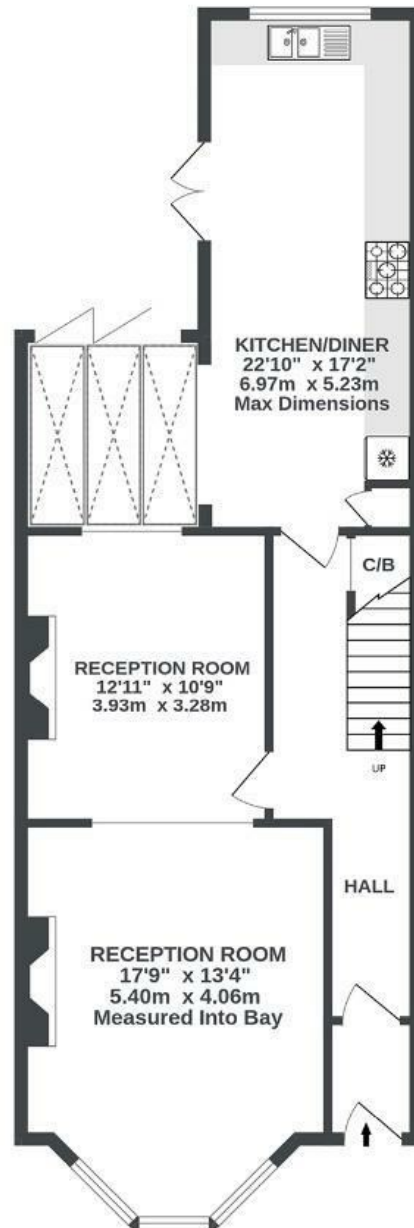

1ST FLOOR
567 sq.ft. (52.7 sq.m.) approx.

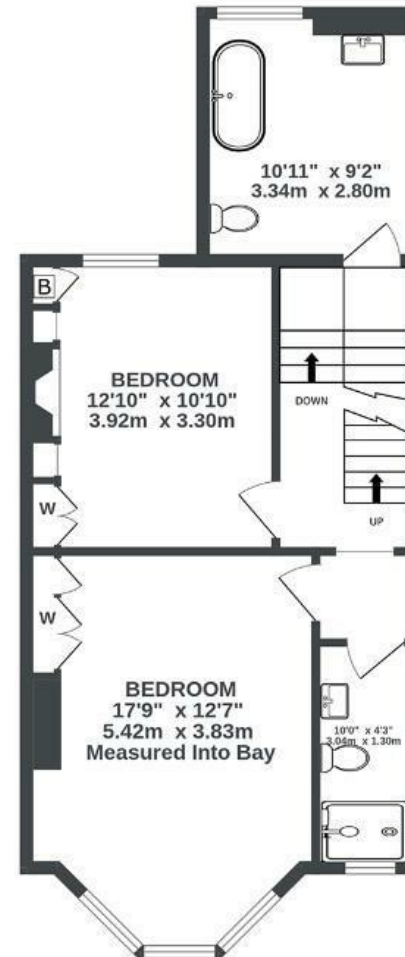

2ND FLOOR
233 sq.ft. (21.7 sq.m.) approx.

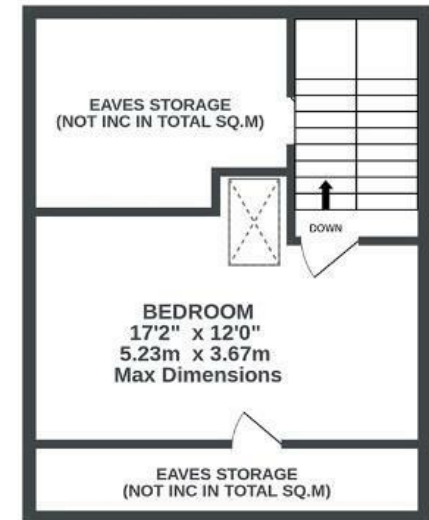

Illustrations are for reference purposes only, measurements are approximate, not to scale.

Boardwalk

Nutgrove Avenue , BRISTOL

£

£725,000



BS3 4QE

zzz

3 Bedrooms



2 Bathrooms

'Being opposite the park has meant that our children can play easily, plus the primary school is in the park, which couldn't have been more convenient for our family. We've enjoyed how the kitchen opens out into the garden, which is pretty quiet and can be so sunny. The view of the park from the front room and bedroom has been a real benefit, watching the world go by. You can hear foxes, owls and it's great for bonfire night and the summer fair.'

