

# Sandy Park Road

## BRISLINGTON

APPROXIMATE FLOOR AREA  
55.0 SQM / 592 SQFT



GROUND FLOOR

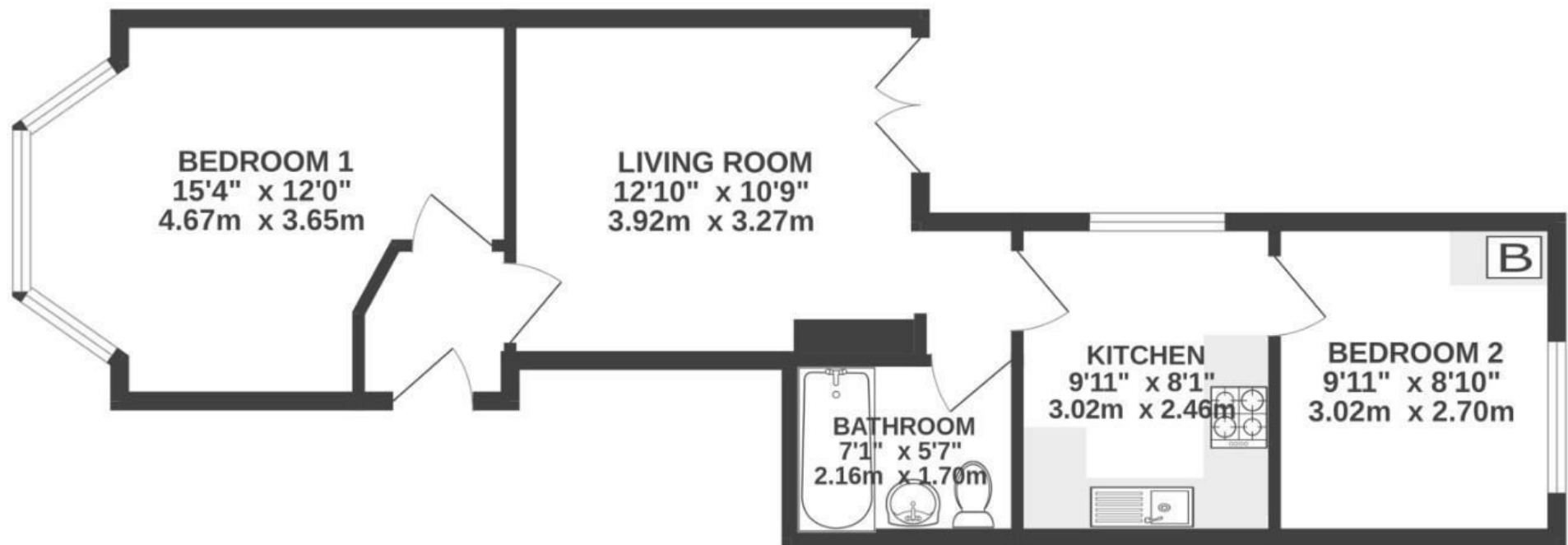

Boardwalk

# Sandy Park Road , BRISTOL



£260,000



2 Bedrooms



BS4 3PG



1 Bathrooms

"We've felt very spoilt living on Sandy Park Road, there's so much going on in the area. The independent businesses have gone from strength to strength here. Favourites on the high street include Italian treats from the Deli, cinnamon buns from café Kin and arty gifts from These Two Hands. It's been great to have options for meeting up with friends locally, whether it's pizza and cocktails at Bocabar or craft beer at Lost & Grounded's tap room. And we've enjoyed many a weekend spending time outdoors in the neighbourhood, from Nightingale Valley woods to Arnos Vale Cemetery and Beese's riverside garden in the summer."

