

Bayswater Road

HORFIELD

APPROXIMATE FLOOR AREA
107.5 SQM / 1157 SQFT



GROUND FLOOR
601 sq.ft. (55.8 sq.m.) approx.

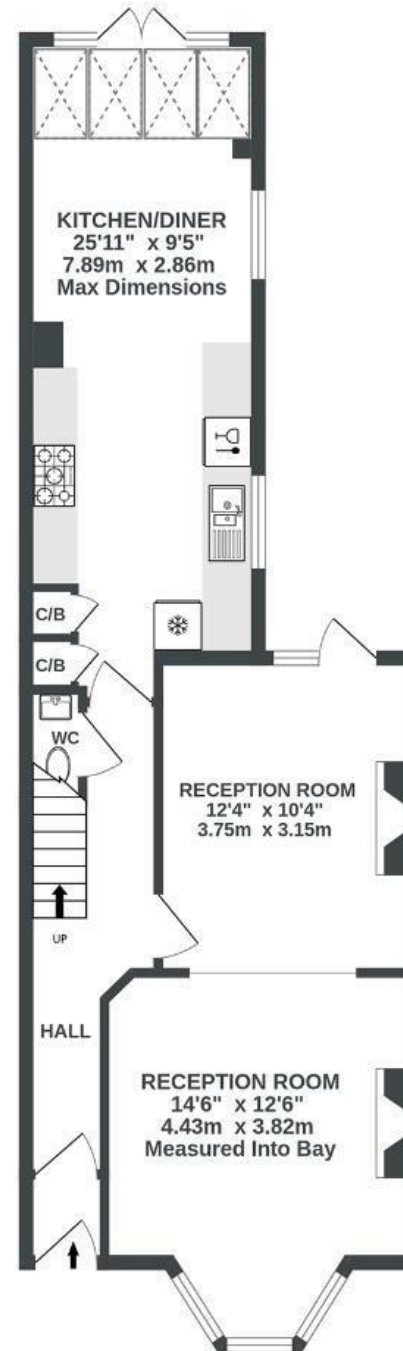

1ST FLOOR
556 sq.ft. (51.7 sq.m.) approx.



Illustrations are for reference purposes only, measurements are approximate, not to scale.

Boardwalk

Bayswater Road

HORFIELD, BRISTOL



£525,000



3 Bedrooms



BS7 0BN



2 Bathrooms

"It's a cosy house on a quiet cul-de-sac with bags of character. We love the south facing garden for the summer and the log burner in the winter. The amenities on Gloucester Road are second to none, three family friendly pubs within five minutes walk and a plethora of cafes that people come from all over Bristol to eat at."

