

Cairns Crescent

ST PAULS

APPROXIMATE FLOOR AREA
85.1 SQM / 916 SQFT



GROUND FLOOR
455 sq.ft. (42.3 sq.m.) approx.

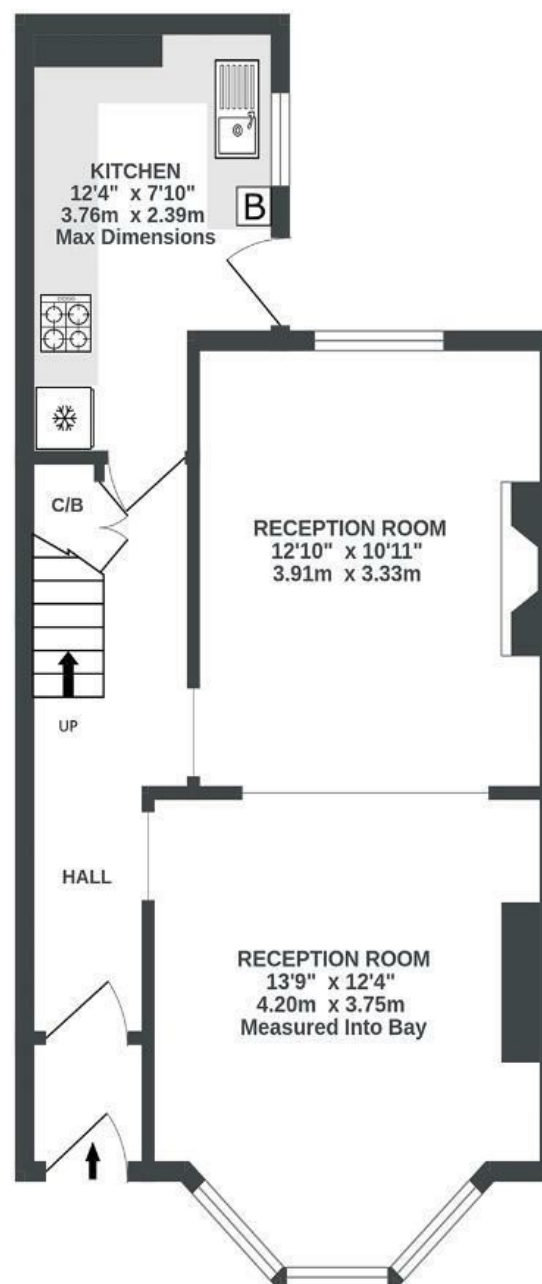

1ST FLOOR
460 sq.ft. (42.8 sq.m.) approx.

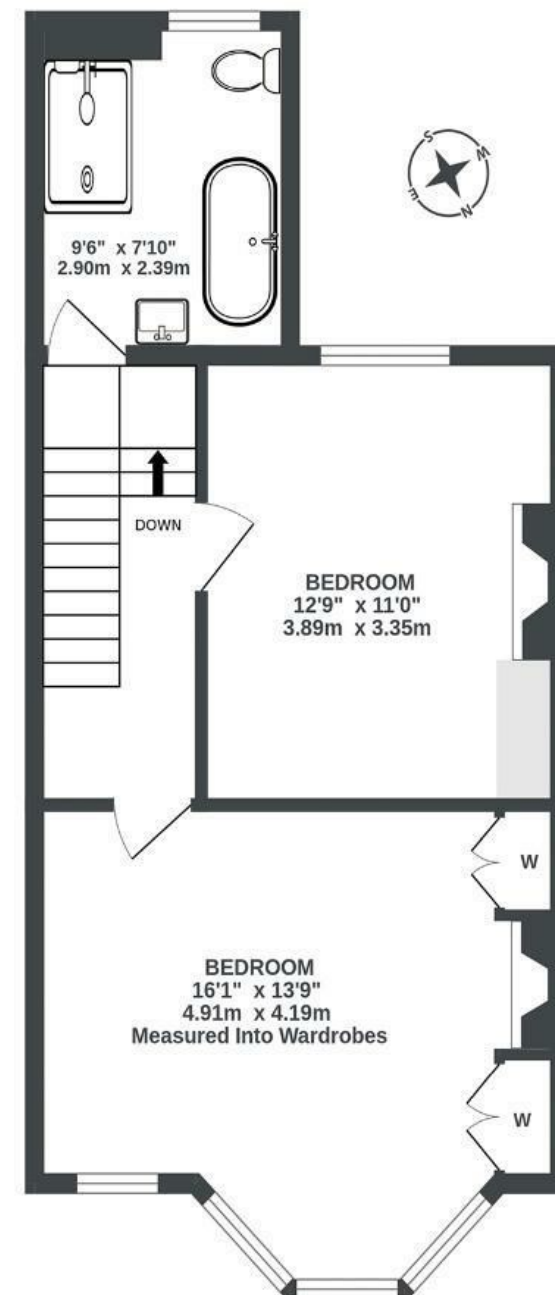

Illustrations are for reference purposes only, measurements are approximate, not to scale.

Boardwalk

Cairns Crescent

ST PAULS, BRISTOL

£

£400,000



BS2 9QD

zzz

2 Bedrooms



1 Bathrooms

"This is a cosy and comfortable home and we have been lucky to start our family here. There are so many amazing places to eat and drink, from Bianchi's and Wang's to Caper & Cure and The Crafty Egg. There are numerous parks just around the corner. Everything in Bristol is within thirty minutes walking distance. We have friendly neighbours on all sides. When we sit out in the garden (a real suntrap in the summer) it's so quiet we can't even hear the cars going by."

