

# Ascot Road

## SOUTHMEAD

APPROXIMATE FLOOR AREA  
72.4 SQM / 780 SQFT



GROUND FLOOR  
391 sq.ft. (36.3 sq.m.) approx.

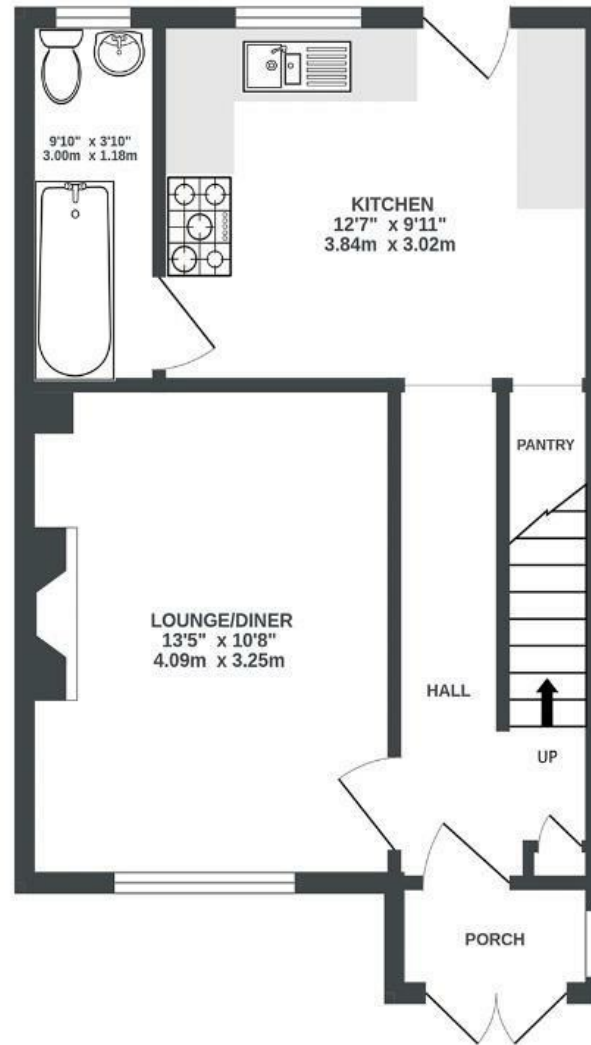

1ST FLOOR  
389 sq.ft. (36.2 sq.m.) approx.

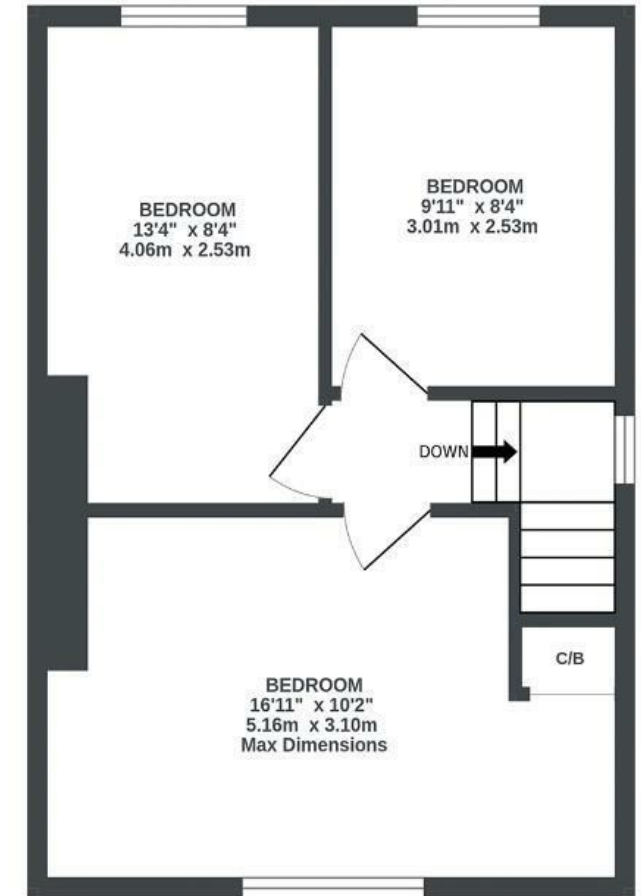

Illustrations are for reference purposes only, measurements are approximate, not to scale.

Boardwalk

# Ascot Road

## SOUTHMEAD, BRISTOL

£

£300,000



BS10 5SW

zzz

3 Bedrooms



1 Bathrooms

*"This has been a wonderful home for 11 years, I love that we are surrounded by green space. The presence of the school and music centre mean that it is quiet at night. I love how bright the living room is in the morning, and love to have breakfast at the table. I also enjoy sitting in there on winters nights reading a book with candles lit and the wood burner on."*

