

Ascot Road

SOUTHMEAD

APPROXIMATE FLOOR AREA
72.4 SQM / 780 SQFT



GROUND FLOOR
391 sq.ft. (36.3 sq.m.) approx.

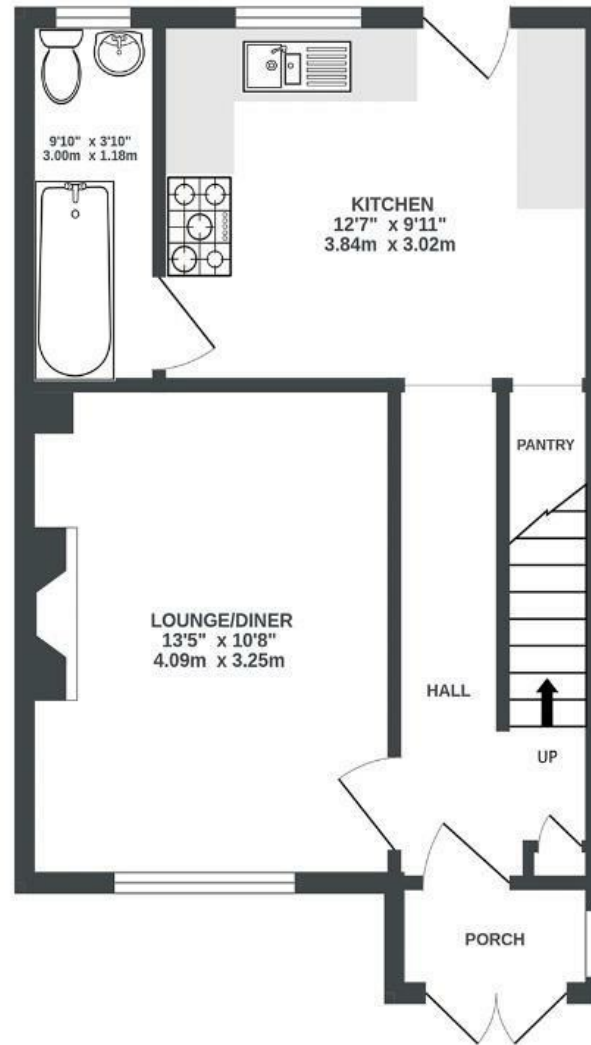

1ST FLOOR
389 sq.ft. (36.2 sq.m.) approx.

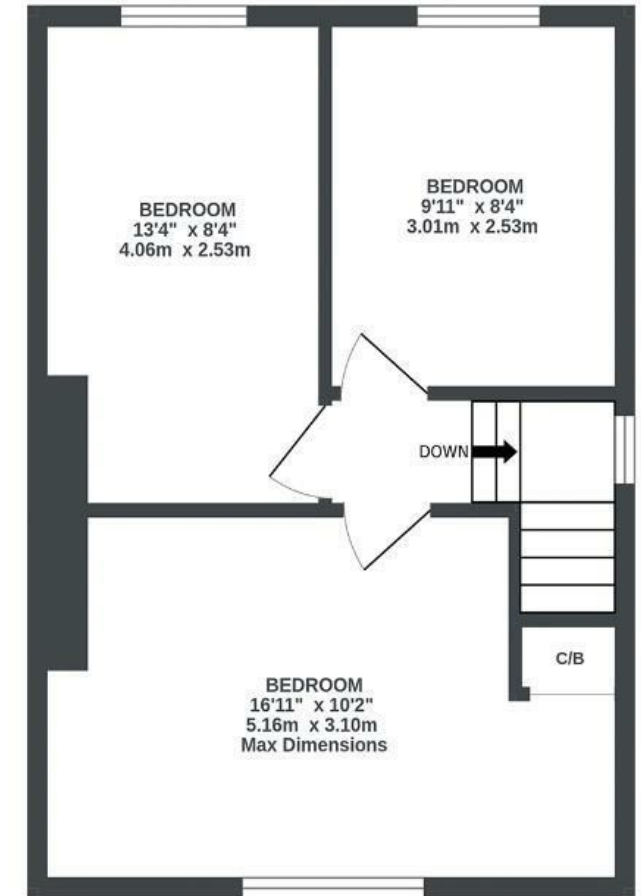

Illustrations are for reference purposes only, measurements are approximate, not to scale.

Boardwalk

Ascot Road

SOUTHMEAD, BRISTOL

£

£300,000



BS10 5SW

zzz

3 Bedrooms



1 Bathrooms

"This has been a wonderful home for 11 years, I love that we are surrounded by green space. The presence of the school and music centre mean that it is quiet at night. I love how bright the living room is in the morning, and love to have breakfast at the table. I also enjoy sitting in there on winters nights reading a book with candles lit and the wood burner on."

