

Sherbourne Street

ST GEORGE

APPROXIMATE FLOOR AREA
87.5 SQM / 942 SQFT



GROUND FLOOR
488 sq.ft. (45.3 sq.m.) approx.



1ST FLOOR
454 sq.ft. (42.2 sq.m.) approx.

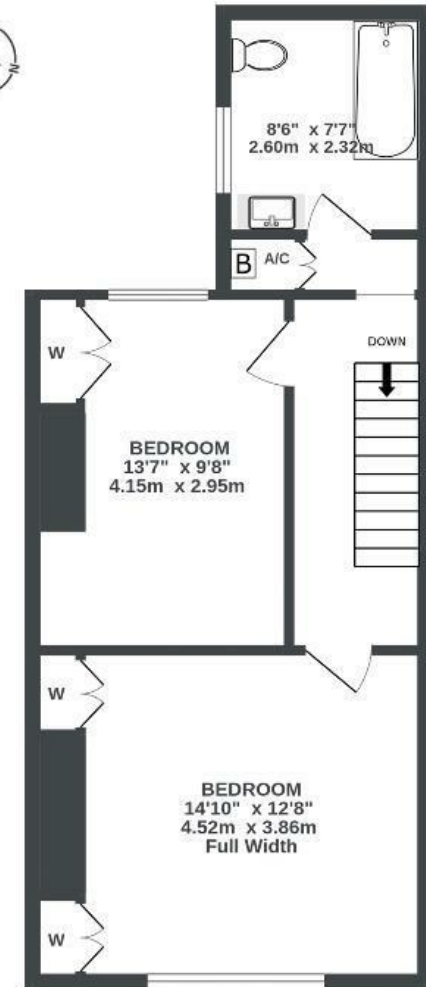

Boardwalk

Sherbourne

ST GEORGE, BRISTOL



£365,000



2 Bedrooms



Bristol, BS5



1 Bathrooms

8FH

"I've completely renovated every inch of my home. I've put a lot of thought into turning my home into a very peaceful and easy home to live in. It has been great being surrounded by parks and green spaces. The area has changed so much and we loved having Poco Deli right at the bottom of our road. The City Centre is only a stone's throw away, but tucked away on our little street it never felt too busy."

