

# Harrowdene Road

KNOWLE

APPROXIMATE FLOOR AREA  
103.9 SQM / 1119 SQFT



GROUND FLOOR  
580 sq.ft. (53.9 sq.m.) approx.

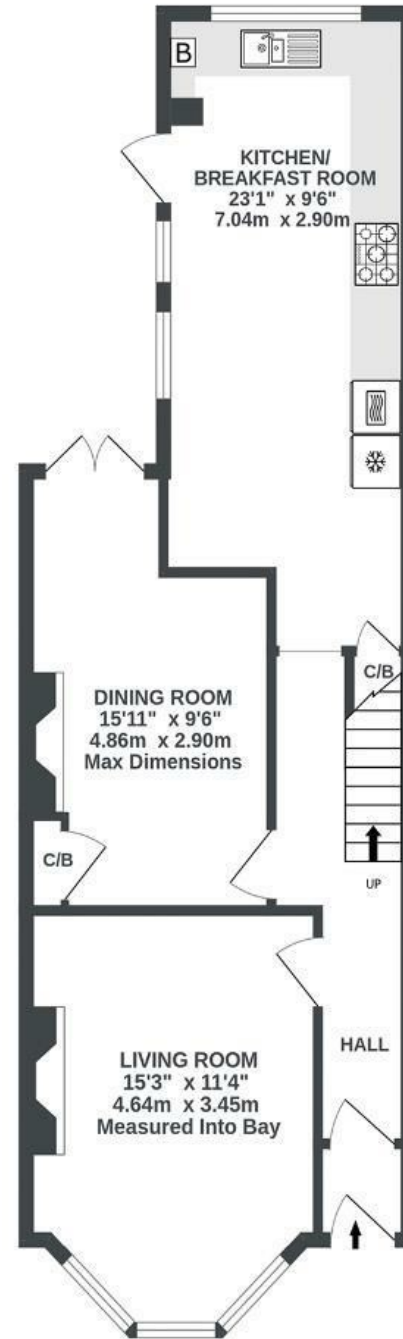

1ST FLOOR  
539 sq.ft. (50.1 sq.m.) approx.



Illustrations are for reference purposes only, measurements are approximate, not to scale.

Boardwalk

# Harrowdene

, BRISTOL

---



£525,000



3 Bedrooms



Bristol, BS4



1 Bathrooms

211

---

*Home is more than just a house, it's a feeling, and Harrowdene Road always felt like home to us. From the moment we moved in, we were welcomed by the other neighbours on the street. There's a genuine sense of community here that we've cherished, we have always felt welcomed and included.*

*We love being able to walk to the city and Temple Meads, how close the local nursery is, not to mention the two large parks where we love taking our dog for walks. The area is vibrant and family-friendly, and it's been a wonderful place to raise our daughter. There's so much to love about this neighbourhood, and we hope the next owners will love living here just as much as we have."*

