

Langton Court Road

ST ANNE'S PARK

APPROXIMATE FLOOR AREA
114.8 SQM / 1236 SQFT



BASEMENT
(NOT INC IN TOTAL SQ.)
0 sq.ft. (0.0 sq.m.) approx.

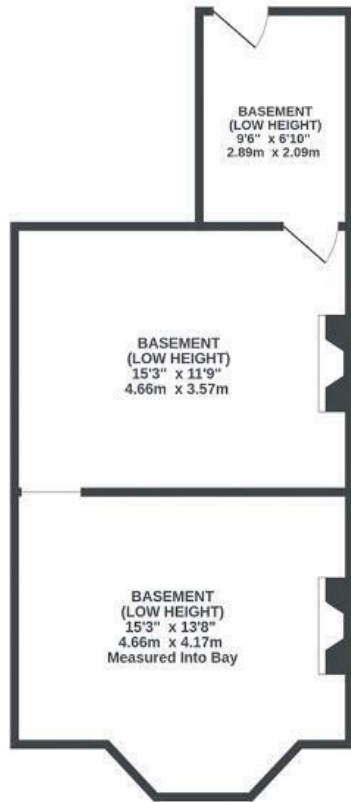

GROUND FLOOR
522 sq.ft. (48.5 sq.m.) approx.



1ST FLOOR
445 sq.ft. (41.3 sq.m.) approx.



2ND FLOOR
269 sq.ft. (25.0 sq.m.) approx.

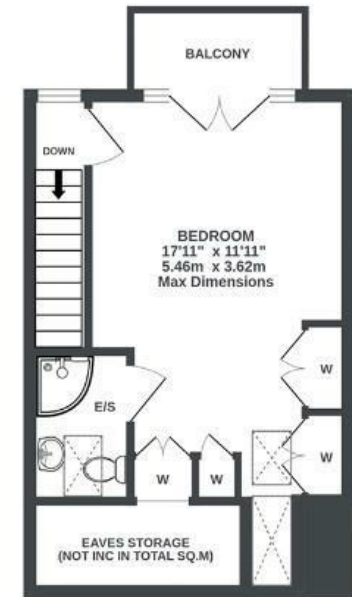

Illustrations are for reference purposes only, measurements are approximate, not to scale.

Boardwalk

Langton Court

BRISLINGTON, BRISTOL

£

£450,000

zzz

4 Bedrooms



Bristol, BS4

4FG



2 Bathrooms

"We've put a lot of time, care and love into updating this house and making it a perfect family home over the last 9 years, we're sad to move on! Our neighbours are lovely and there is a real sense of community on the street. I would definitely recommend checking out The Langton and Beese's for a relaxing drink by the river."

