

Petersway Gardens

ST GEORGE

APPROXIMATE FLOOR AREA
69 SQM / 742 SQFT



GROUND FLOOR

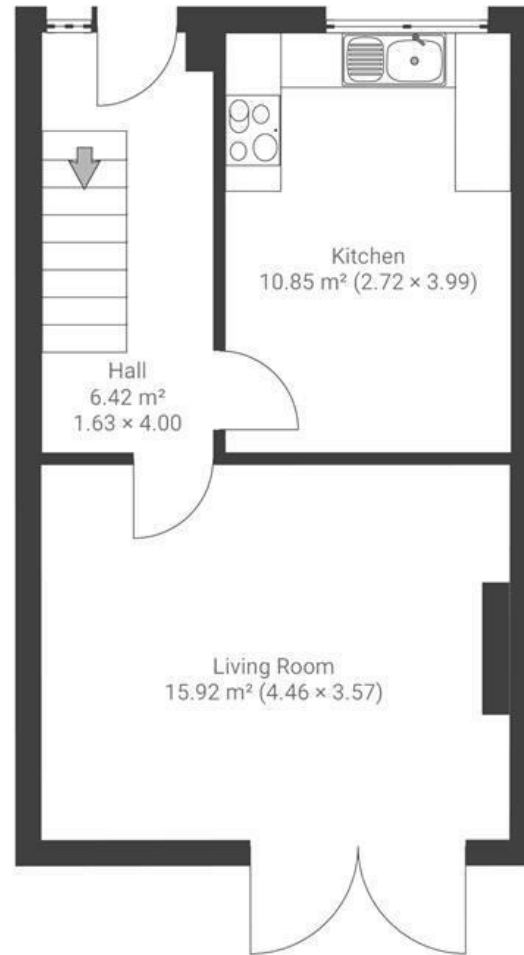

FIRST FLOOR



Boardwalk

Petersway

ST GEORGE, BRISTOL



£300,000



3 Bedrooms



Bristol, BS5
8TA



1 Bathrooms

"An ideal street, and area to raise a family. Quiet cul-de-sac to allow children to play outside"

