

Seymour Road

BISHOPSTON

APPROXIMATE FLOOR AREA
124.7 SQM / 1342 SQFT



GARAGE (NOT IN SITU)
0 sq.ft. (0.0 sq.m.) approx.



GROUND FLOOR
736 sq.ft. (68.4 sq.m.) approx.

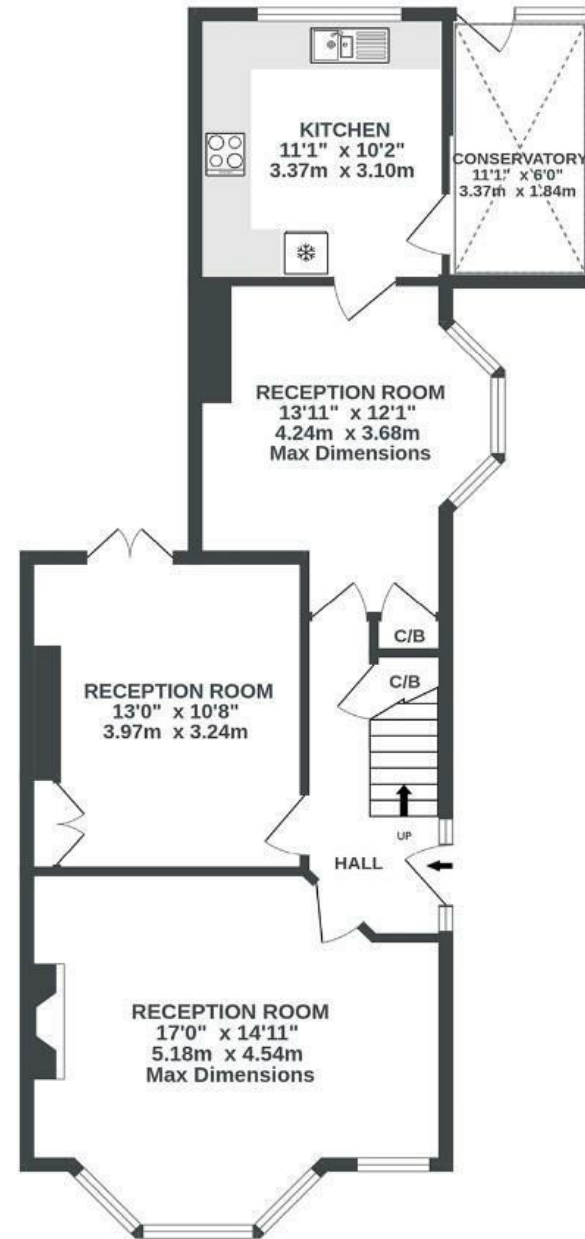

1ST FLOOR
606 sq.ft. (56.3 sq.m.) approx.



Illustrations are for reference purposes only, measurements are approximate, not to scale.

Boardwalk

Seymour Road

BISHOPSTON, BRISTOL



£585,000



3 Bedrooms



Bristol, BS7



1 Bathrooms

9HR

"Bishopston is a wonderful place to live. There are wonderful restaurants, coffee shops, delis and independent shops of all varieties within walking distance, which has been a joy! St Andrews Park and Horfield Common are very close and wonderful for children – or people of any age. Schools are very good, and I found it a real benefit that my daughters were able to walk to school. Neighbours in Seymour Road and Dongola Road are very friendly and there is a strong community spirit."

