

# Wingfield Road

KNOWLE

APPROXIMATE FLOOR AREA  
120.4 SQM / 1296 SQFT



GROUND FLOOR  
806 sq.ft. (74.9 sq.m.) approx.



1ST FLOOR  
490 sq.ft. (45.5 sq.m.) approx.

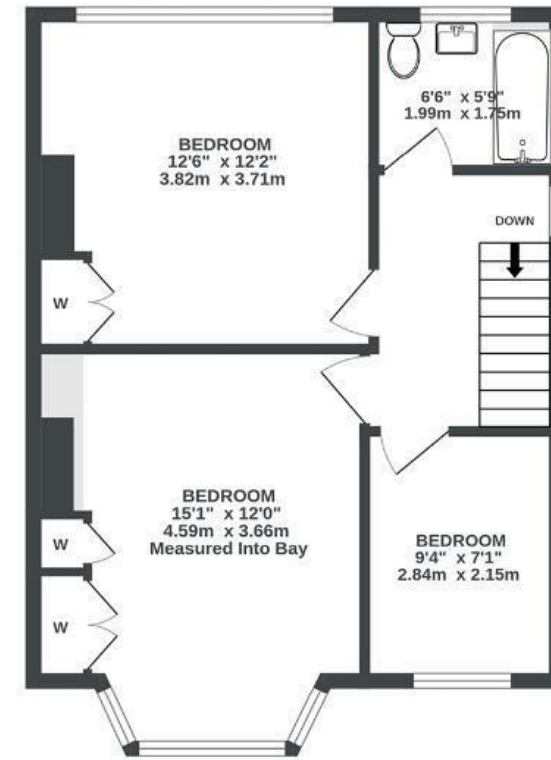

Illustrations are for reference purposes only, measurements are approximate, not to scale.

Boardwalk

# Wingfield Road

, BRISTOL



£575,000



3 Bedrooms



Bristol, BS3

5FF



2 Bathrooms

*“We’ve loved living on Wingfield Road and have enjoyed renovating the house into our colourful home. We’ll miss our slow Saturday mornings around the kitchen and hosting garden parties for our friends. Many happy memories of summer bbq’s and toasting marshmallows in the fire pit while watching the sunset over Bristol from the garden. We hope the next owners will love it as much as we have.”*

